

Resin Caster (φ75)

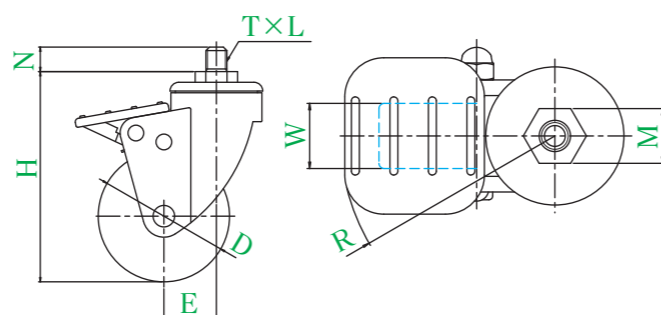

Resin caster: φ75M12×14

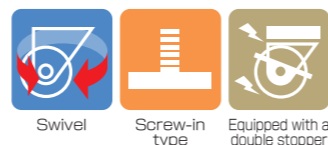

Bracket = Stainless steel

Product number	Wheels	Wheel diameter	Wheel width	Mounting height	Screw	Pitch	Length	Opposite side	Eccentricity	Turning radius	Allowance load	Wheel weight
		D(mm)	W(mm)	H(mm)	T	L	N(mm)	M(mm)	E(mm)	R(mm)	daN(kgf)	(g)
Resin caster (φ 75)	Urethane wheels	75	25	120	M12	1.75	14	21	30	83	60(61.2)	360

- Quiet and smooth rotation is kept for a long time by using the radial ball bearing at the revolving portion.
- Since resin (nylon) is used for body and stainless steel is used for bracket, this caster provides superior corrosion resistance and water resistance.
- This caster is equipped with the double stopper that can lock rotation of the mounting portion and wheel.
- ★ Refer to P7 for the mounting method.

PARALLELCASTER

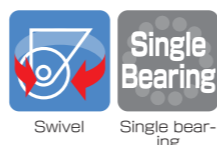

PARALLEL CASTER

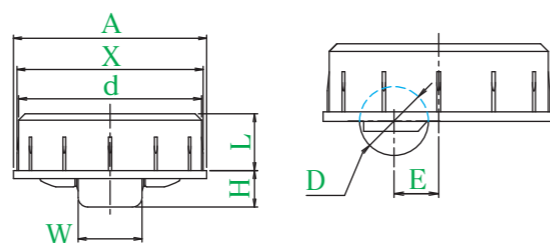

Installation diagram

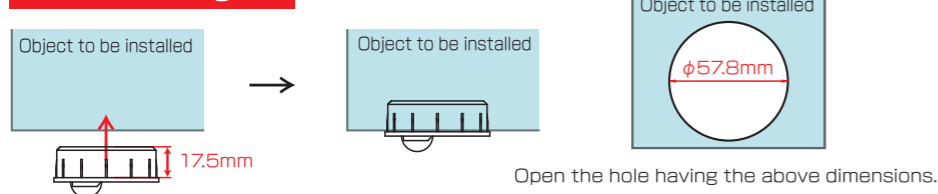

Install a caster in such a manner that the caster is embedded in the product. Dimensions of the portion in which the caster is embedded are as follows: Height: 17.5mm or higher, Hole diameter: φ57.8mm

Body, wheel = Nylon

Product number	Wheel diameter	Wheel width	Mounting height	L(mm)	d(mm)	A(mm)	X(mm)	Eccentricity	Allowance load	Wheel weight
	D(mm)	W(mm)	H(mm)					E(mm)	daN(kgf)	(g)
PARALLEL CASTER	18	20	11.5	17.5	57.3	61	58.3	11.7	30(30.6)	55

- This is the low profile caster having proprietary design.
- Since this caster can be easily mounted, this caster is widely used, such as furniture.

Custom - made items

We provide wheels having various special specifications according to customers' requests.

Wheels



Conductive rubber wheels

Static electricity can be removed. These wheels are suitable for transporting products in which short-circuit caused by static electricity shall be prevented.

Supported series ▶ J, J2, SJ, S, E, G, L, SA, SUS-S, SUS-E



Urethane wheel providing antistatic properties

In comparison with normal wheels, this wheel is less electric conductive and absorption of dust and dirt due to static electricity is prevented.

Supported series ▶ J, SJ, S, E, SA, SUS-E



Heat-resistant phenol wheel

This heat-resistant wheel can resist at the maximum of 200°C. This wheel is suitable for use under high temperature environment.

Supported series ▶ J, J2, SJ



White rubber wheel/ gray rubber wheel

Color of rubber wheel is set to white or gray to prevent leaving marks on the floor surface after traveling.

This rubber wheel provides elasticity and traveling performance and has structure in which stain is considered.

Supported series ▶ J, J2, SJ



Wide wheel

This wheel has the same wheel width as that of conventional casters, but has larger ground contact area in order to prevent the wheel from being stuck in a ditch.

Supported series ▶ J, PM, J2

Special casters

We can consult manufacturing of special casters meeting your request.

If you cannot find wheels having requested dimensions in the catalog, please contact your nearest branch or sales office.

* Please understand that there is a case that we cannot meet your request.