

4. How to View Pages of Products

JSERIES These series are mainly used for a platform carrier transporting a heavy articles and widely used for general industries.

JTYPE

These are descriptions for each product.

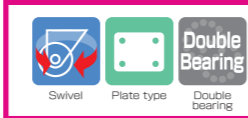

Specifications of products are described. *Refer to P24 for descriptions of icons.

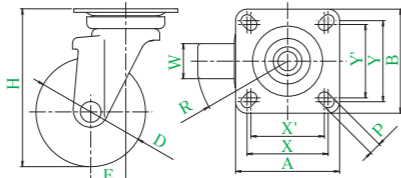

How to find a product number is described.

Bracket = Trivalent unichrome coating

This is description about the bracket.

Product number	Wheels	Wheel diameter	Wheel width	Mounting height	Mounting base	Mounting dimensions	Hole diameter	Eccentricity	Turning radius	Allowance load	Wheel weight
		D(mm)	W(mm)	H(mm)	A × B(mm)	X × Y(X' × Y') (mm)	P(mm)	E(mm)	R(mm)	daN(kgf)	(g)
J-75	Rubber wheel with steel plate wheel assembly (including B)	75	32	103	82 × 82	63 × 63	9.5	26	64	80(81.6)	580
	Urethane wheel with steel plate wheel assembly (including B)									120(122.4)	700
	Urethane wheel with nylon wheel assembly (including B)									100(102.0)	540
J-100	Rubber wheel with steel plate wheel assembly (including B)	100	32	144	95 × 95	74 × 74 (67 × 67)	11	32	82	120(122.4)	1090
	Urethane wheel with steel plate wheel assembly (including B)									100(102.0)	970
	Urethane wheel with nylon wheel assembly (including B)									180(183.6)	1170
J-130	Rubber wheel with steel plate wheel assembly (including B)	130	40	177	105 × 105	82 × 82 (75 × 75)	11	40	105	180(183.6)	1880
	Urethane wheel with steel plate wheel assembly (including B)									180(183.6)	1490
	Urethane wheel with nylon wheel assembly (including B)									250(255.0)	2030
J-150	Rubber wheel with steel plate wheel assembly (including B)	150	40	198	120 × 120	94 × 94 (87 × 87)	11	40	115	200(204.0)	2120
	Urethane wheel with steel plate wheel assembly (including B)									200(204.0)	1680
	Urethane wheel with nylon wheel assembly (including B)									300(306.0)	2380
J-200	Rubber wheel with steel plate wheel assembly (including B)	200	42	250	140 × 140	115 × 115 (105 × 105)	11.5	56	156	250(255.0)	3800
	Urethane wheel with steel plate wheel assembly (including B)									400(408.0)	3980
	Urethane wheel with nylon wheel assembly (including B)									250(255.0)	3290

- The axle diameter of the rubber wheel with nylon wheel assembly (including B) having wheel diameter of φ 130 and φ 150 is φ 12.
- The rubber wheel with conductive steel plate wheel assembly (including B) having wheel diameter of φ 100 and φ 150 can be manufactured.
- The urethane wheel with antistatic steel plate wheel assembly (including B) having wheel diameter of φ 100 to φ 200 can be manufactured.

Wheel in use Refer to P153 for detailed specifications.



W Rubber wheel with steel plate wheel assembly (including B)
NR Rubber wheel with nylon wheel assembly (including B)
UW Urethane wheel with steel plate wheel assembly (including B)
GU Urethane wheel with nylon wheel assembly (including B)

Different colors are used for each wheel.

These are descriptions regarding wheels used in products.

* (including B) indicates wheels equipped with bearing.

JTYPE

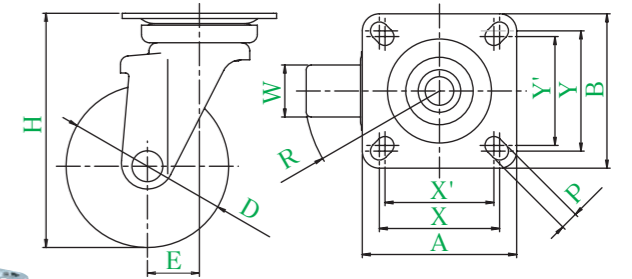
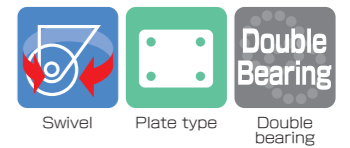

Bracket = Trivalent unichrome coating

Product number	Wheels	Wheel diameter	Wheel width	Mounting height	Mounting base	Mounting dimensions	Hole diameter	Eccentricity	Turning radius	Allowance load	Wheel weight
		D(mm)	W(mm)	H(mm)	A × B(mm)	X × Y(X' × Y') (mm)	P(mm)	E(mm)	R(mm)	daN(kgf)	(g)
J-75	Rubber wheel with steel plate wheel assembly (including B)	75	32	103	82 × 82	63 × 63	9.5	26	64	80(81.6)	580
	Urethane wheel with steel plate wheel assembly (including B)									120(122.4)	700
	Urethane wheel with nylon wheel assembly (including B)									100(102.0)	540
J-100	Rubber wheel with steel plate wheel assembly (including B)	100	32	144	95 × 95	74 × 74 (67 × 67)	11	32	82	120(122.4)	1090
	Urethane wheel with steel plate wheel assembly (including B)									100(102.0)	970
	Urethane wheel with nylon wheel assembly (including B)									180(183.6)	1170
J-130	Rubber wheel with steel plate wheel assembly (including B)	130	40	177	105 × 105	82 × 82 (75 × 75)	11	40	105	180(183.6)	1880
	Urethane wheel with steel plate wheel assembly (including B)									180(183.6)	1490
	Urethane wheel with nylon wheel assembly (including B)									250(255.0)	2030
J-150	Rubber wheel with steel plate wheel assembly (including B)	150	40	198	120 × 120	94 × 94 (87 × 87)	11	40	115	200(204.0)	2120
	Urethane wheel with steel plate wheel assembly (including B)									200(204.0)	1680
	Urethane wheel with nylon wheel assembly (including B)									300(306.0)	2380
J-200	Rubber wheel with steel plate wheel assembly (including B)	200	42	250	140 × 140	115 × 115 (105 × 105)	11.5	56	156	250(255.0)	3800
	Urethane wheel with steel plate wheel assembly (including B)									400(408.0)	3980
	Urethane wheel with nylon wheel assembly (including B)									250(255.0)	3290

- The axle diameter of the rubber wheel with nylon wheel assembly (including B) having wheel diameter of φ 130 and φ 150 is φ 12.
- The rubber wheel with conductive steel plate wheel assembly (including B) having wheel diameter of φ 100 and φ 150 can be manufactured.
- The urethane wheel with antistatic steel plate wheel assembly (including B) having wheel diameter of φ 100 to φ 200 can be manufactured.

Wheel in use Refer to P153 for detailed specifications.

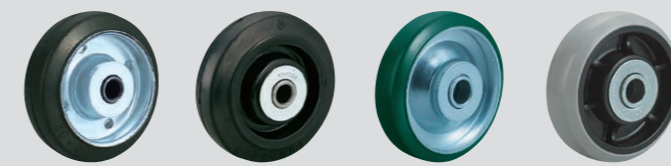

W Rubber wheel with steel plate wheel assembly (including B)
NR Rubber wheel with nylon wheel assembly (including B)
UW Urethane wheel with steel plate wheel assembly (including B)
GU Urethane wheel with nylon wheel assembly (including B)

JB TYPE

• Equipped with a lever type double stopper

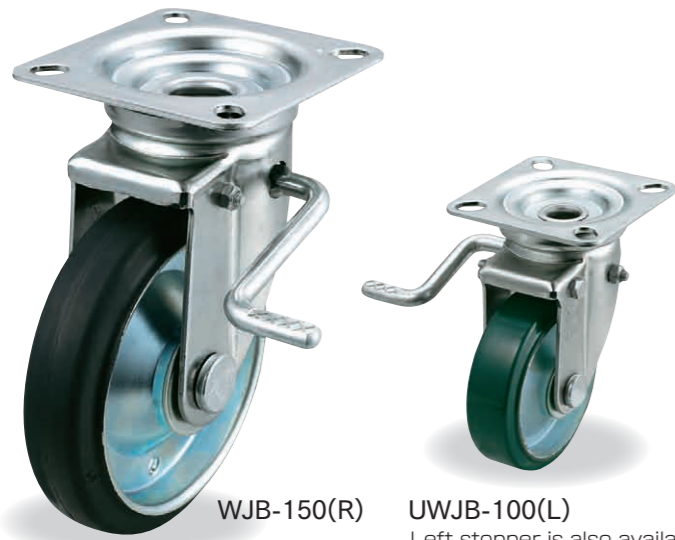
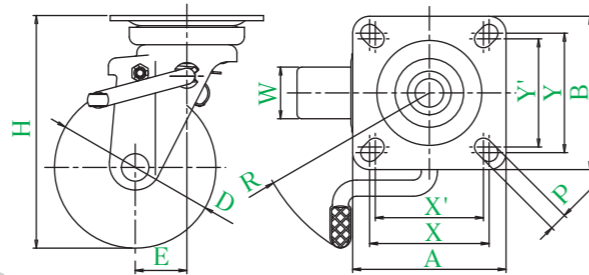
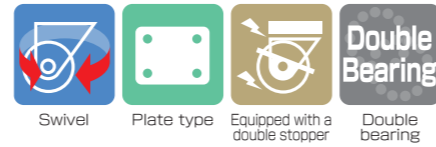

WJB-150(R)

UWJB-100(L)

Left stopper is also available.
(Wheel diameter: φ 100 to φ 200)

● Description of product number
Please specify the right stopper (R) and the left stopper (L).

UW J B - 100(R or L)

Wheel type	Equipped with a double stopper Bracket type	Wheel diameter	Lever type stopper	Right-Left
------------	---	----------------	--------------------	------------

Bracket = Trivalent unichrome coating

Product number	Wheels	Wheel diameter	Wheel width	Mounting height	Mounting base	Mounting dimensions	Hole diameter	Eccentricity	Turning radius	Allowance load	Wheel weight
		D (mm)	W (mm)	H (mm)	A × B (mm)	X × Y (X' × Y') (mm)	P (mm)	E (mm)	R (mm)	daN(kgf)	(g)
WJB-75 (R)	Rubber wheel with steel plate wheel assembly (including B)	75	32	103	82 × 82	63 × 63	9.5	26	84	80(81.6)	630
	Urethane wheel with steel plate wheel assembly (including B)									120(122.4)	750
	Urethane wheel with nylon wheel assembly (including B)									100(102.0)	490
WJB-100 (R or L)	Rubber wheel with steel plate wheel assembly (including B)	100	32	144	95 × 95	74 × 74 (67 × 67)	11	32	112	120(122.4)	1240
	Rubber wheel with nylon wheel assembly (including B)									100(102.0)	1130
	Urethane wheel with steel plate wheel assembly (including B)									180(183.6)	1340
	Urethane wheel with nylon wheel assembly (including B)									100(102.0)	1140
	Rubber wheel with steel plate wheel assembly (including B)									180(183.6)	2300
	Rubber wheel with nylon wheel assembly (including B)									180(183.6)	1660
WJB-130 (R or L)	Rubber wheel with steel plate wheel assembly (including B)	130	40	177	105 × 105	82 × 82 (75 × 75)	11	40	133	180(183.6)	2200
	Rubber wheel with nylon wheel assembly (including B)		35							250(255.0)	2200
	Urethane wheel with steel plate wheel assembly (including B)		40							180(183.6)	1915
	Urethane wheel with nylon wheel assembly (including B)		40							200(204.0)	2600
	Rubber wheel with nylon wheel assembly (including B)		40							200(204.0)	1850
	Urethane wheel with steel plate wheel assembly (including B)		38							300(306.0)	2550
WJB-150 (R or L)	Rubber wheel with steel plate wheel assembly (including B)	150	40	198	120 × 120	94 × 94 (87 × 87)	11	40	133	200(204.0)	2210
	Rubber wheel with nylon wheel assembly (including B)		40							250(255.0)	4000
	Urethane wheel with steel plate wheel assembly (including B)		38							400(408.0)	4150
	Urethane wheel with nylon wheel assembly (including B)		40							200(204.0)	2330
	Rubber wheel with steel plate wheel assembly (including B)		43							250(255.0)	4000
	Rubber wheel with nylon wheel assembly (including B)		42							400(408.0)	4150
WJB-200 (R or L)	Rubber wheel with steel plate wheel assembly (including B)	200	42	250	140 × 140	115 × 115 (105 × 105)	11.5	56	156	400(408.0)	4150
	Urethane wheel with steel plate wheel assembly (including B)									250(255.0)	3460
	Urethane wheel with nylon wheel assembly (including B)									43	250(255.0)

- This caster is equipped with the double stopper that can lock turning of the mounting portion and wheel.
- The axle diameter of the rubber wheel with nylon wheel assembly (including B) having wheel diameter of φ 130 and φ 150 is φ 12.
- The rubber wheel with conductive steel plate wheel assembly (including B) having wheel diameter of φ 100 and φ 150 can be manufactured.
- The urethane wheel with antistatic steel wheel plate assembly (including B) having wheel diameter of φ 100 to φ 200 can be manufactured.
- The left stopper is not stocked.

Wheel in use Refer to P153 for detailed specifications.

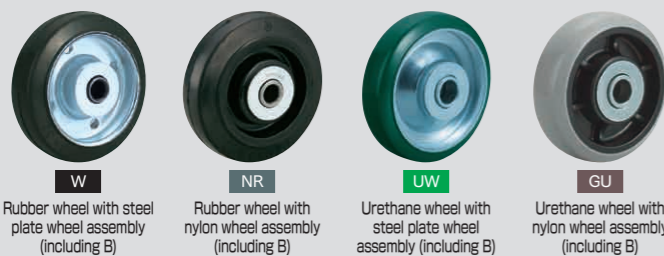

JB TYPE

• Equipped with a pedal type double stopper

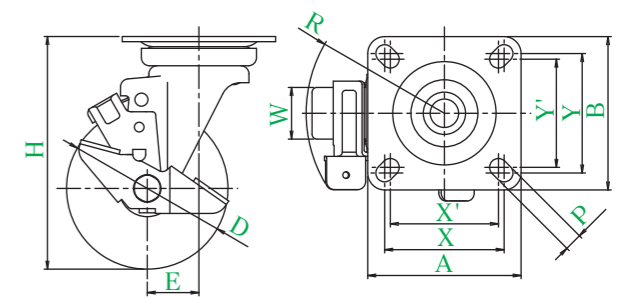
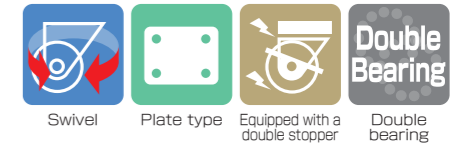

GUJB-100

● Description of product number

GU J B - 100

Wheel diameter	Equipped with a double stopper Bracket type	Wheel type
----------------	---	------------

Bracket = Trivalent unichrome coating

Product number	Wheels	Wheel diameter	Wheel width	Mounting height	Mounting base	Mounting dimensions	Hole diameter	Eccentricity	Turning radius	Allowance load	Wheel weight
		D (mm)	W (mm)	H (mm)	A × B (mm)	X × Y (X' × Y') (mm)	P (mm)	E (mm)	R (mm)	daN(kgf)	(g)
WJB-100	Rubber wheel with steel plate wheel assembly (including B)	100	32	144	95 × 95	74 × 74 (67 × 67)	11	32	86	120(122.4)	1220
	Rubber wheel with nylon wheel assembly (including B)									100(102.0)	1120
	Urethane wheel with steel plate wheel assembly (including B)									180(183.6)	1320
WJB-130	Rubber wheel with steel plate wheel assembly (including B)	130	40	177	105 × 105	82 × 82 (75 × 75)	11	40	108	180(183.6)	2180
	Rubber wheel with nylon wheel assembly (including B)		35							180(183.6)	1780
	Urethane wheel with steel plate wheel assembly (including B)		40							250(255.0)	2320
	Urethane wheel with nylon wheel assembly (including B)		40							180(183.6)	2035
	Rubber wheel with steel plate wheel assembly (including B)		40							200(204.0)	2420
	Rubber wheel with nylon wheel assembly (including B)		40							200(204.0)	1970
WJB-150	Rubber wheel with steel plate wheel assembly (including B)	150	40	198	120 × 120	94 × 94 (87 × 87)	11	40	115	200(204.0)	2420
	Rubber wheel with nylon wheel assembly (including B)		38							300(306.0)	2670
	Urethane wheel with steel plate wheel assembly (including B)		40							200(204.0)	2330

- This caster is equipped with the double stopper that can lock turning of the mounting portion and wheel.
- The axle diameter of the rubber wheel with nylon wheel assembly (including B) having wheel diameter of φ 130 and φ 150 is φ 12.
- The rubber wheel with conductive steel plate wheel assembly (including B) having wheel diameter of φ 100 and φ 150 can be manufactured.
- The urethane wheel with antistatic steel wheel plate assembly (including B) having wheel diameter of φ 100 to φ 200 can be manufactured.

☆ Utility Model No.2607715

Wheel in use Refer to P153 for detailed specifications.

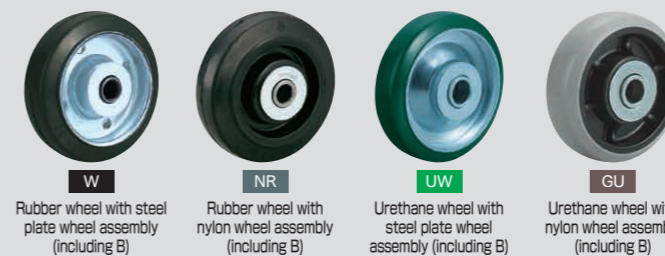

J-S TYPE

• Equipped with a pedal type single stopper



UWJ-100S

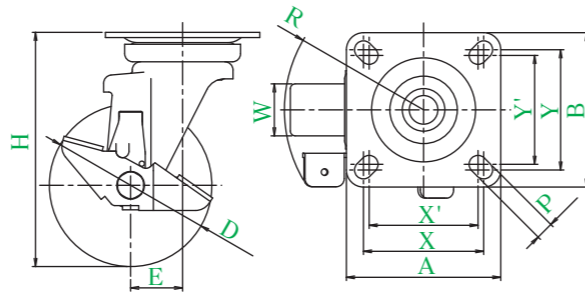
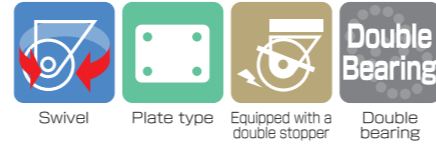

● Description of product number

UW J - 100 S

Wheel type	Bracket type	Wheel diameter	Equipped with a single stopper
------------	--------------	----------------	--------------------------------

Bracket = Trivalent unichrome coating

Product number	Wheels	Wheel diameter	Wheel width	Mounting height	Mounting base	Mounting dimensions	Hole diameter	Eccentricity	Turning radius	Allowance load	Wheel weight
		D(mm)	W(mm)	H(mm)	A × B(mm)	X × Y(X' × Y') (mm)	P(mm)	E(mm)	R(mm)	daN(kgf)	(g)
W NR UW GU J-100 S	Rubber wheel with steel plate wheel assembly (including B) Rubber wheel with nylon wheel assembly (including B) Urethane wheel with steel plate wheel assembly (including B) Urethane wheel with nylon wheel assembly (including B)	100	32	144	95 × 95	74 × 74 (67 × 67)	11	32	86	120(122.4)	1180
										100(102.0)	1070
										180(183.6)	1330
										100(102.0)	1080
W NR UW GU J-130 S	Rubber wheel with steel plate wheel assembly (including B) Rubber wheel with nylon wheel assembly (including B) Urethane wheel with steel plate wheel assembly (including B) Urethane wheel with nylon wheel assembly (including B)	130	40	177	105 × 105	82 × 82 (75 × 75)	11	40	108	180(183.6)	2080
										180(183.6)	1700
			35							250(255.0)	2240
			40							180(183.6)	1955
W NR UW GU J-150 S	Rubber wheel with steel plate wheel assembly (including B) Rubber wheel with nylon wheel assembly (including B) Urethane wheel with steel plate wheel assembly (including B) Urethane wheel with nylon wheel assembly (including B)	150	40	198	120 × 120	94 × 94 (87 × 87)	11	40	115	200(204.0)	2340
										38	200(204.0)
			40							300(306.0)	2590
			40							200(204.0)	2250
W UW GU J-200 S	Rubber wheel with steel plate wheel assembly (including B) Urethane wheel with steel plate wheel assembly (including B) Urethane wheel with nylon wheel assembly (including B)	200	43	250	140 × 140	115 × 115 (105 × 105)	11.5	56	156	250(255.0)	4180
			42							400(408.0)	4320
			43							250(255.0)	3630

- These casters are used for only locking rotation of the wheel.
- The axle diameter of the rubber wheel with nylon wheel assembly (including B) having wheel diameter of φ 130 and φ 150 is φ 12.
- The rubber wheel with conductive steel plate wheel assembly (including B) having wheel diameter of φ 100 and φ 150 can be manufactured.
- The urethane wheel with antistatic steel wheel plate assembly (including B) having wheel diameter of φ 100 to φ 200 can be manufactured.

Wheel in use

Refer to P153 for detailed specifications.

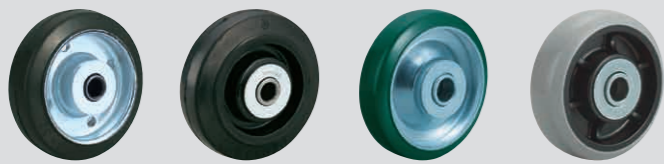

W Rubber wheel with steel plate wheel assembly (including B)
NR Rubber wheel with nylon wheel assembly (including B)
UW Urethane wheel with steel plate wheel assembly (including B)
GU Urethane wheel with nylon wheel assembly (including B)

K TYPE

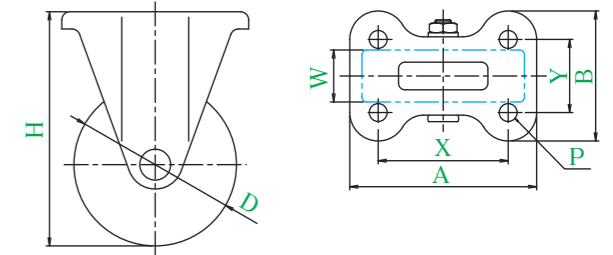
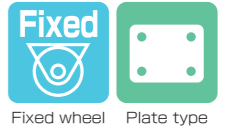

UWK-150

● Description of product number

UW K - 150

Wheel type	Bracket type	Wheel diameter
------------	--------------	----------------

Bracket = Trivalent unichrome coating

Product number	Wheels	Wheel diameter	Wheel width	Mounting height	Mounting base	Mounting dimensions	Hole diameter	Allowance load	Wheel weight
		D(mm)	W(mm)	H(mm)	A × B(mm)	X × Y(mm)	P(mm)	daN(kgf)	(g)
W UW GU K-75	Rubber wheel with steel plate wheel assembly (including B) Urethane wheel with steel plate wheel assembly (including B) Urethane wheel with nylon wheel assembly (including B)	75	32	103	95 × 72	63 × 40	9.5	80(81.6)	430
								120(122.4)	540
								100(102.0)	390
W NR UW GU K-100	Rubber wheel with steel plate wheel assembly (including B) Rubber wheel with nylon wheel assembly (including B) Urethane wheel with steel plate wheel assembly (including B) Urethane wheel with nylon wheel assembly (including B)	100	32	144	115 × 80	80 × 45	11	120(122.4)	700
								100(102.0)	770
								180(183.6)	930
								100(102.0)	760
W NR UW GU K-130	Rubber wheel with steel plate wheel assembly (including B) Rubber wheel with nylon wheel assembly (including B) Urethane wheel with steel plate wheel assembly (including B) Urethane wheel with nylon wheel assembly (including B)	130	40	177	137 × 93	100 × 56	11	180(183.6)	1490
								180(183.6)	1090
			35					250(255.0)	1630
			40					180(183.6)	1345
W NR UW GU K-150	Rubber wheel with steel plate wheel assembly (including B) Rubber wheel with nylon wheel assembly (including B) Urethane wheel with steel plate wheel assembly (including B) Urethane wheel with nylon wheel assembly (including B)	150	40	198	137 × 93	100 × 56	11	200(204.0)	1650
								38	200(204.0)
			40					300(306.0)	1910
			40					200(204.0)	1570
W UW GU K-200	Rubber wheel with steel plate wheel assembly (including B) Urethane wheel with steel plate wheel assembly (including B) Urethane wheel with nylon wheel assembly (including B)	200	43	250	151 × 102	112 × 63	11.5	250(255.0)	3060
			42					400(408.0)	3230
			43					250(255.0)	2540

- The axle diameter of the rubber wheel with nylon wheel assembly (including B) having wheel diameter of φ 130 and φ 150 is φ 12.
- The rubber wheel with conductive steel plate wheel assembly (including B) having wheel diameter of φ 100 and φ 150 can be manufactured.
- The urethane wheel with antistatic steel wheel plate assembly (including B) having wheel diameter of φ 100 to φ 200 can be manufactured.

Wheel in use

Refer to P153 for detailed specifications.

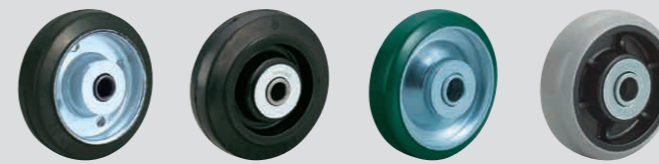

W Rubber wheel with steel plate wheel assembly (including B)
NR Rubber wheel with nylon wheel assembly (including B)
UW Urethane wheel with steel plate wheel assembly (including B)
GU Urethane wheel with nylon wheel assembly (including B)

KB TYPE

• Equipped with a lever type single stopper

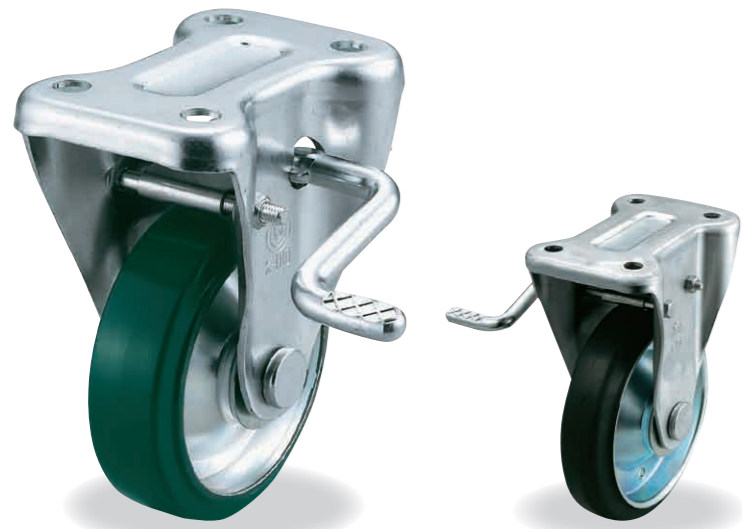

UWKB-100(R)

WKB-150(L)

Left stopper is also available.

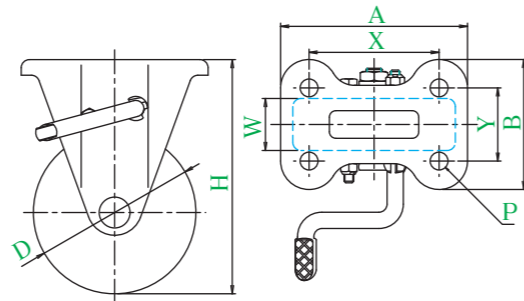
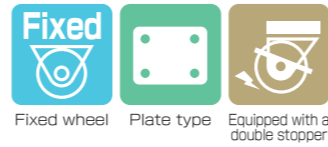

● Description of product number
Please specify the right stopper (R) and the left stopper (L).

UW K B - 150(R or L)

Wheel type
Bracket type
Equipped with a single stopper
Wheel diameter
Lever type stopper
Right-Left

Bracket = Trivalent unichrome coating

Product number	Wheels	Wheel diameter	Wheel width	Mounting height	Mounting base	Mounting dimensions	Hole diameter	Allowance load	Wheel weight
		D(mm)	W(mm)	H(mm)	A × B(mm)	X × Y(mm)	P(mm)	daN(kgf)	(g)
KB-100 (R or L)	Rubber wheel with steel plate wheel assembly (including B)	100	32	144	115 × 80	80 × 45	11	120(122.4)	980
	Rubber wheel with nylon wheel assembly (including B)							100(102.0)	880
	Urethane wheel with steel plate wheel assembly (including B)							180(183.6)	1060
	Urethane wheel with nylon wheel assembly (including B)							100(102.0)	890
KB-130 (R or L)	Rubber wheel with steel plate wheel assembly (including B)	130	40	177	137 × 93	100 × 56	11	180(183.6)	1660
	Rubber wheel with nylon wheel assembly (including B)		35					1260	
	Urethane wheel with steel plate wheel assembly (including B)		40					1800	
	Urethane wheel with nylon wheel assembly (including B)		40					1515	
KB-150 (R or L)	Rubber wheel with steel plate wheel assembly (including B)	150	40	198	137 × 93	100 × 56	11	200(204.0)	1820
	Rubber wheel with nylon wheel assembly (including B)		38					1390	
	Urethane wheel with steel plate wheel assembly (including B)		40					2090	
	Urethane wheel with nylon wheel assembly (including B)		40					1750	
KB-200 (R or L)	Rubber wheel with steel plate wheel assembly (including B)	200	43	250	151 × 102	112 × 63	11.5	250(255.0)	3260
	Urethane wheel with steel plate wheel assembly (including B)		42					3400	
	Urethane wheel with nylon wheel assembly (including B)		43					2710	

- These casters are used for only locking rotation of the wheel.
- The axle diameter of the rubber wheel with nylon wheel assembly (including B) having wheel diameter of φ 130 and φ 150 is φ 12.
- The rubber wheel with conductive steel plate wheel assembly (including B) having wheel diameter of φ 100 and φ 150 can be manufactured.
- The urethane wheel with antistatic steel wheel plate assembly (including B) having wheel diameter of φ 100 to φ 200 can be manufactured.
- The left stopper is not stocked.

Wheel in use

Refer to P153 for detailed specifications.



W Rubber wheel with steel plate wheel assembly (including B)
NR Rubber wheel with nylon wheel assembly (including B)
UW Urethane wheel with steel plate wheel assembly (including B)
GU Urethane wheel with nylon wheel assembly (including B)

JK TYPE

• Spirally fixing type



WJK-150

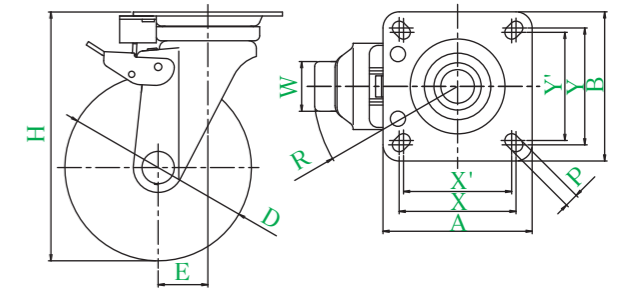
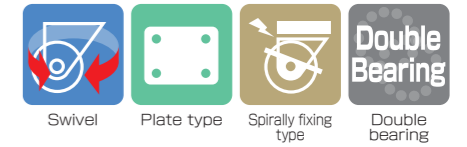

● Description of product number

UW JK - 150

Wheel type
Bracket type
Wheel diameter

Bracket = Trivalent unichrome coating

Product number	Wheels	Wheel diameter	Wheel width	Mounting height	Mounting base	Mounting dimensions	Hole diameter	Eccentricity	Turning radius	Allowance load	Wheel weight
		D(mm)	W(mm)	H(mm)	A × B(mm)	X × Y(X' × Y') (mm)	P(mm)	E(mm)	R(mm)	daN(kgf)	(g)
JK-150	Rubber wheel with steel plate wheel assembly (including B)	150	40	198	120 × 120	94 × 94 (87 × 87)	11	40	115	200(204.0)	2320
	Rubber wheel with nylon wheel assembly (including B)									200(204.0)	1865
	Urethane wheel with steel plate wheel assembly (including B)									300(306.0)	2570
	Urethane wheel with nylon wheel assembly (including B)									200(204.0)	2040

- Swivel and fixed wheel can be switched with one touch operation.
- The axle diameter of the rubber wheel with nylon wheel assembly (including B) is φ 12.
- The rubber wheel with conductive steel plate wheel assembly (including B) and the urethane wheel with antistatic steel plate wheel assembly (including B) can be manufactured.

☆ Utility Model No.3014588

Wheel in use

Refer to P153 for detailed specifications.



W Rubber wheel with steel plate wheel assembly (including B)
NR Rubber wheel with nylon wheel assembly (including B)
UW Urethane wheel with steel plate wheel assembly (including B)
GU Urethane wheel with nylon wheel assembly (including B)

JK-S TYPE

- Equipped with a pedal type single stopper
- Spirally fixing type

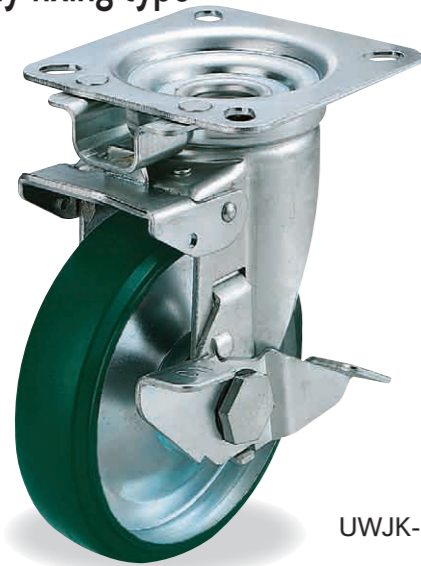

UWJK-150S

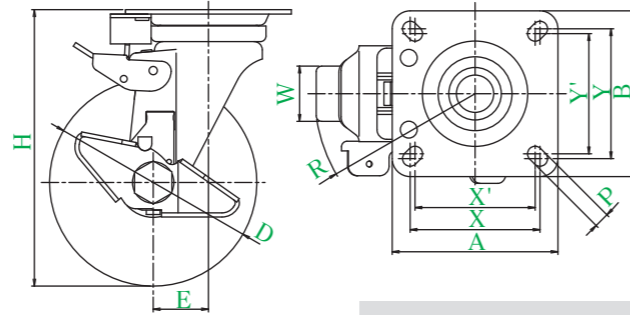
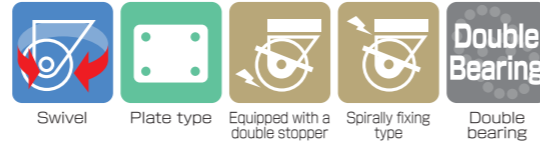

● Description of product number
UW JK - 150 S
 Wheel type
 Bracket type
 Wheel diameter
 Equipped with a single stopper

Bracket = Trivalent unichrome coating

Product number	Wheels	Wheel diameter	Wheel width	Mounting height	Mounting base	Mounting dimensions	Hole diameter	Eccentricity	Turning radius	Allowance load	Wheel weight
		D(mm)	W(mm)	H(mm)	A × B(mm)	X × Y(X' × Y') (mm)	P(mm)	E(mm)	R(mm)	daN(kgf)	(g)
JK-150 S	W	150	40	198	120 × 120	94 × 94 (87 × 87)	11	40	115	200(204.0)	2510
	NR		38							200(204.0)	2015
	UW		40							300(306.0)	2780
	GU		40							200(204.0)	2190

- This is a caster manufactured by providing the wheel lock function to JK type. Each caster can be used independently.
- Swivel and fixed wheel can be switched with one touch operation.
- The wheel diameter of the rubber wheel with nylon wheel assembly (including B) is φ 12.
- The rubber wheel with conductive steel plate wheel assembly (including B) and the urethane wheel with antistatic steel plate wheel assembly (including B) can be manufactured.

☆ Utility Model No.3014588

Wheel in use Refer to P153 for detailed specifications.

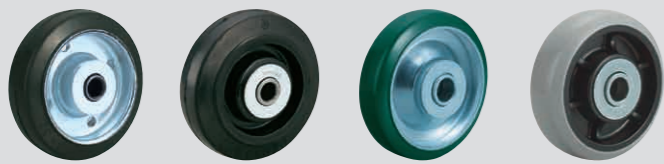

W Rubber wheel with steel plate wheel assembly (including B)
 NR Rubber wheel with nylon wheel assembly (including B)
 UW Urethane wheel with steel plate wheel assembly (including B)
 GU Urethane wheel with nylon wheel assembly (including B)

■ New industrial casters

PM SERIES

This is a new caster suitable for towing!

Point 1 Long life
 Realizing life more than 3 times longer than that of conventional products

In comparison with our general casters, traveling distance of J series casters is more than 3 times longer than that of general casters. Since life span of the caster is long, running cost is significantly reduced.

Point 2 Stable traveling performance
 Preventing resonance (vibration of casters) during towing!!

Resonance that occurs while towing and significantly reduces life of casters is prevented. Impact on the revolving portion caused by resonance is reduced, and wear of wheels is significantly reduced.

Point 3 Easy operability
 Load during turning is reduced for approximately 40%!!

When the caster is rotating, maximum load is applied when operating a truck. For PM series, load during towing is reduced for approximately 40% compared with conventional items.



PMS TYPE

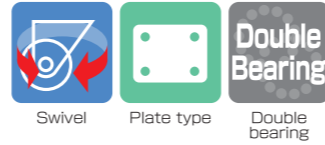

PMS-150AW

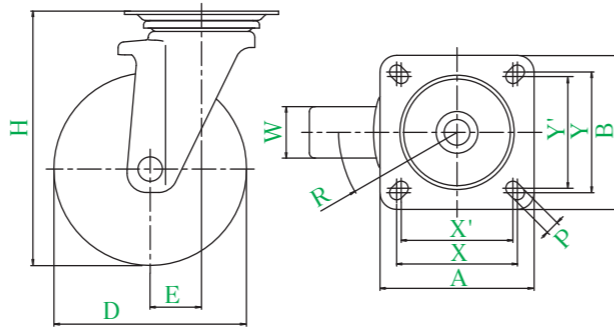

● Description of product number
PMS - 150 AW
 Bracket type Wheel diameter Wheel type

Bracket = Trivalent unichrome coating

Product number	Wheels	Wheel diameter	Wheel width	Mounting height	Mounting base	Mounting dimensions	Hole diameter	Eccentricity	Turning radius	Allowance load	Wheel weight
		D(mm)	W(mm)	H(mm)	A × B(mm)	X × Y (X' × Y') (mm)	P(mm)	E(mm)	R(mm)	daN(kgf)	(g)
PMS-130	WB	130	40	177	110 × 110	90 × 90 (80 × 80)	11	40	105	180(183.6)	1640
	UWB		35							250(255.0)	2020
PMS-150	WB	150	40	198	120 × 120	94 × 94 (87 × 87)	11	40	115	200(204.0)	1880
	AW		42							250(255.0)	2000
	UWB		38							300(306.0)	2350
PMS-200	WB	200	43	250	144 × 144	120 × 120 (105 × 105)	11.5	56	156	250(255.0)	3775
	AW		45							300(306.0)	3800
	UWB		42							400(408.0)	3855

● For casters having wheel diameter of φ 150 and rubber wheel with steel plate wheel assembly (including B), wide wheel can be manufactured.
 * Refer to P154 for detailed specifications.

Wheel in use Refer to P153 for detailed specifications.



WB Rubber wheel with steel plate wheel assembly (including B)
 AW Rubber wheel with aluminum wheel assembly (including B)
 UWB Urethane wheel with steel plate wheel assembly (including B)

PMS-LB TYPE

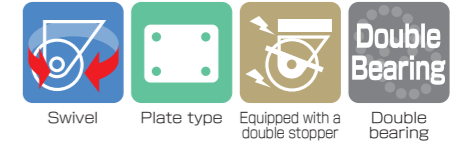

● Equipped with a lever type double stopper



PMS-150WBLB(R)

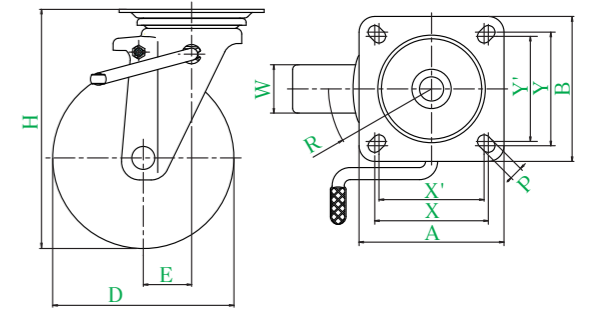

● Description of product number
PMS - 150 WB LB(R)
 Bracket type Wheel diameter Wheel type Stopper Lever type Right-L

Bracket = Trivalent unichrome coating

Product number	Wheels	Wheel diameter	Wheel width	Mounting height	Mounting base	Mounting dimensions	Hole diameter	Eccentricity	Turning radius	Allowance load	Wheel weight
		D(mm)	W(mm)	H(mm)	A × B(mm)	X × Y (X' × Y') (mm)	P(mm)	E(mm)	R(mm)	daN(kgf)	(g)
PMS-130	WB	130	40	177	110 × 110	90 × 90 (80 × 80)	11	40	138	180(183.6)	1870
	UWB		35							250(255.0)	2250
PMS-150	WB	150	40	198	120 × 120	94 × 94 (87 × 87)	11	40	138	200(204.0)	2110
	AW		42							250(255.0)	2230
	UWB		38							300(306.0)	2580
PMS-200	WB	200	43	250	144 × 144	120 × 120 (105 × 105)	11.5	56	156	250(255.0)	4025
	AW		45							300(306.0)	4050
	UWB		42							400(408.0)	4105

● This caster is equipped with the double stopper that can lock turning of the mounting portion and wheel.
 ● For casters having wheel diameter of φ 150 and rubber wheel with steel plate wheel assembly (including B), wide wheel can be manufactured.
 * Refer to P154 for detailed specifications.

Wheel in use Refer to P153 for detailed specifications.



WB Rubber wheel with steel plate wheel assembly (including B)
 AW Rubber wheel with aluminum wheel assembly (including B)
 UWB Urethane wheel with steel plate wheel assembly (including B)

PMR TYPE

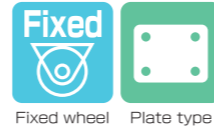

PMR-150UWB

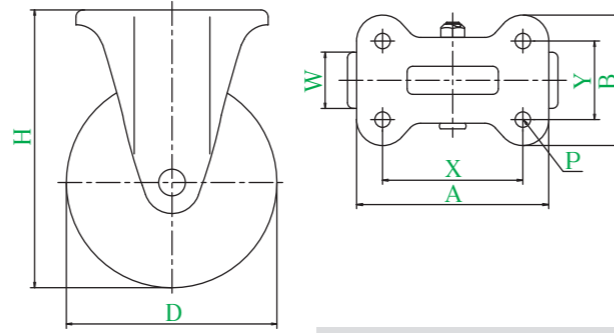

● Description of product number
PMR - 150 UWB
 Bracket type
 Wheel diameter
 Wheel type

Bracket = Trivalent unichrome coating

Product number	Wheels	Wheel diameter	Wheel width	Mounting height	Mounting base	Mounting dimensions	Hole diameter	Allowance load	Wheel weight
		D(mm)	W(mm)	H(mm)	A × B(mm)	X × Y(mm)	P(mm)	daN(kgf)	(g)
PMR-130	WB	130	40	177	137 × 93	100 × 56	11	180(183.6)	1260
	UWB		35					250(255.0)	1650
PMR-150	WB	150	40	198	137 × 93	100 × 56	11	200(204.0)	1480
	AW		42					250(255.0)	1600
PMR-200	UWB	200	38	250	151 × 102	112 × 63	11.5	300(306.0)	1950
	WB		43					250(255.0)	3150
	AW		45					300(306.0)	3170
	UWB		42					400(408.0)	3230

● For casters having wheel diameter of φ 150 and rubber wheel with steel plate wheel assembly (including B), wide wheel can be manufactured.
 * Refer to P154 for detailed specifications.

Wheel in use

Refer to P153 for detailed specifications.



WB Rubber wheel with steel plate wheel assembly (including B)
 AW Rubber wheel with aluminum wheel assembly (including B)
 UWB Urethane wheel with steel plate wheel assembly (including B)

J₂ TYPE

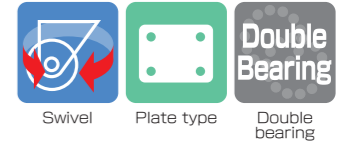

GUJ2-150

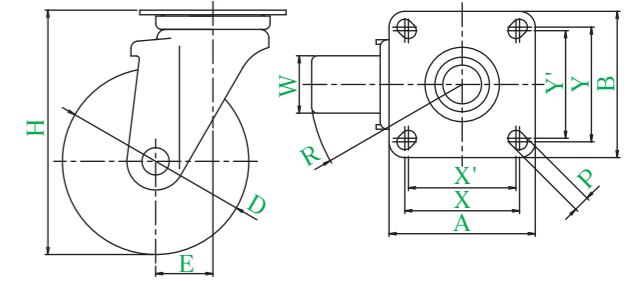

● Description of product number
GU J₂ - 150
 Wheel diameter
 Bracket type
 Wheel type

Bracket = Trivalent unichrome coating

Product number	Wheels	Wheel diameter	Wheel width	Mounting height	Mounting base	Mounting dimensions	Hole diameter	Eccentricity	Turning radius	Allowance load	Wheel weight
		D(mm)	W(mm)	H(mm)	A × B(mm)	X × Y(X' × Y') (mm)	P(mm)	E(mm)	R(mm)	daN(kgf)	(g)
W NR N GU	J ₂ -130	130	40	170	102 × 102	80 × 80 (75 × 75)	11	40	105	160(163.2)	1600
										160(163.2)	1430
										150(153.0)	1395
										160(163.2)	1465
W NR N GU	J ₂ -150	150	40	190	102 × 102	80 × 80 (75 × 75)	11	40	115	180(183.6)	1760
										180(183.6)	1550
										160(163.2)	1470
										180(183.6)	1510

● The rubber wheel with conductive steel plate wheel assembly (including B) having wheel diameter of φ 150 can be manufactured.

Wheel in use

Refer to P154 for detailed specifications.



W Rubber wheel with steel plate wheel assembly (including B)
 NR Rubber wheel with nylon wheel assembly (including B)
 N Nylon wheel (including B)
 GU Urethane wheel with nylon wheel assembly (including B)

J₂-S TYPE

• Equipped with a pedal type single stopper



WJ2-150S

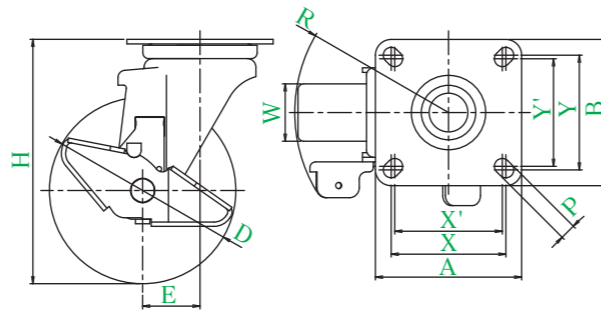
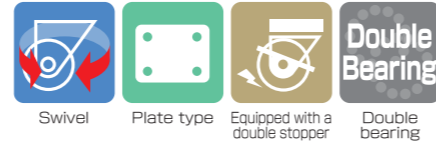

● Description of product number

W J₂ - 150 S

Wheel diameter
Bracket type
Equipped with stopper

Bracket = Trivalent unichrome coating

Product number	Wheels	Wheel diameter	Wheel width	Mounting height	Mounting base	Mounting dimensions	Hole diameter	Eccentricity	Turning radius	Allowance load	Wheel weight
		D(mm)	W(mm)	H(mm)	A × B(mm)	X × Y(X' × Y') (mm)	P(mm)	E(mm)	R(mm)	daN(kgf)	(g)
W NR N GU J ₂ -130 S	Rubber wheel with steel plate wheel assembly (including B)	130	40	170	102 × 102	80 × 80 (75 × 75)	11	40	108	160(163.2)	1800
	Rubber wheel with nylon wheel assembly (including B)									160(163.2)	1630
	Nylon wheel (including B)									150(153.0)	1595
	Urethane wheel with nylon wheel assembly (including B)									160(163.2)	1665
W NR N GU J ₂ -150 S	Rubber wheel with steel plate wheel assembly (including B)	150	40	190	102 × 102	80 × 80 (75 × 75)	11	40	115	180(183.6)	1950
	Rubber wheel with nylon wheel assembly (including B)									180(183.6)	1740
	Nylon wheel (including B)									160(163.2)	1660
	Urethane wheel with nylon wheel assembly (including B)									180(183.6)	1700

- These casters are used for only locking rotation of the wheel.
- The rubber wheel with conductive steel plate wheel assembly (including B) having wheel diameter of φ 150 can be manufactured.

Wheel in use

Refer to P154 for detailed specifications.



W Rubber wheel with steel plate wheel assembly (including B)
NR Rubber wheel with nylon wheel assembly (including B)
N Nylon wheel (including B)
GU Urethane wheel with nylon wheel assembly (including B)

K₂ TYPE

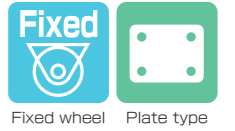

WK2-150



WK2-130

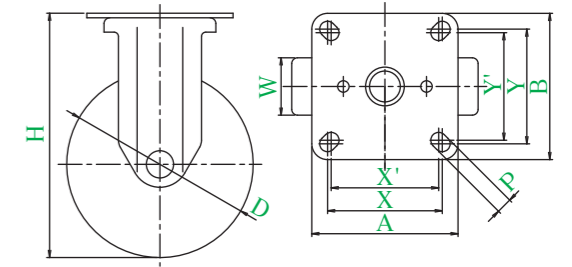

● Description of product number

W K₂ - 150

Wheel diameter
Bracket type

Bracket = Trivalent unichrome coating

Product number	Wheels	Wheel diameter	Wheel width	Mounting height	Mounting base	Mounting dimensions	Hole diameter	Allowance load	Wheel weight
		D(mm)	W(mm)	H(mm)	A × B(mm)	X × Y(X' × Y') (mm)	P(mm)	daN(kgf)	(g)
W NR N GU K ₂ -130	Rubber wheel with steel plate wheel assembly (including B)	130	40	170	102 × 102	80 × 80 (75 × 75)	11	160(163.2)	1390
	Rubber wheel with nylon wheel assembly (including B)							160(163.2)	1245
	Nylon wheel (including B)							150(153.0)	1195
	Urethane wheel with nylon wheel assembly (including B)							160(163.2)	1100
W NR N GU K ₂ -150	Rubber wheel with steel plate wheel assembly (including B)	150	40	190	104 × 110	80 × 80 (75 × 75)	11	180(183.6)	1410
	Rubber wheel with nylon wheel assembly (including B)							180(183.6)	1200
	Nylon wheel (including B)							160(163.2)	1100
	Urethane wheel with nylon wheel assembly (including B)							180(183.6)	1140

- The rubber wheel with conductive steel plate wheel assembly (including B) having wheel diameter of φ 150 can be manufactured.

Wheel in use

Refer to P154 for detailed specifications.



W Rubber wheel with steel plate wheel assembly (including B)
NR Rubber wheel with nylon wheel assembly (including B)
N Nylon wheel (including B)
GU Urethane wheel with nylon wheel assembly (including B)

J₂K TYPE

• Spirally fixing type



WJ2K-150

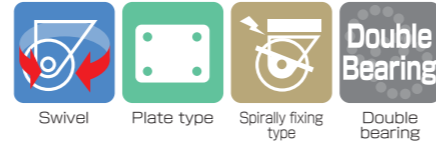
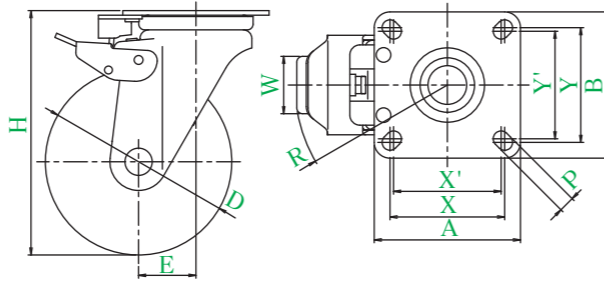

● Description of product number

W J₂K - 150

Wheel type	Bracket type	Wheel diameter
------------	--------------	----------------

Bracket = Trivalent unichrome coating

Product number	Wheels	Wheel diameter	Wheel width	Mounting height	Mounting base	Mounting dimensions	Hole diameter	Eccentricity	Turning radius	Allowance load	Wheel weight
		D(mm)	W(mm)	H(mm)	A × B(mm)	X × Y (X' × Y') (mm)	P(mm)	E(mm)	R(mm)	daN(kgf)	(g)
W NR N GU	Rubber wheel with steel plate wheel assembly (including B)	130	40	170	102 × 102	80 × 80 (75 × 75)	11	40	105	160(163.2)	1760
	Rubber wheel with nylon wheel assembly (including B)									160(163.2)	1460
	Nylon wheel (including B)									150(153.0)	1410
	Urethane wheel with nylon wheel assembly (including B)									160(163.2)	1440
W NR N GU	Rubber wheel with steel plate wheel assembly (including B)	150	40	190	102 × 102	80 × 80 (75 × 75)	11	40	115	180(183.6)	1860
	Rubber wheel with nylon wheel assembly (including B)									180(183.6)	1720
	Nylon wheel (including B)									160(163.2)	1655
	Urethane wheel with nylon wheel assembly (including B)									180(183.6)	1640

- Swivel and fixed wheel can be switched with one touch operation.
- The rubber wheel with conductive steel plate wheel assembly (including B) having wheel diameter of φ 150 can be manufactured.

☆ Utility Model No.3014588

Wheel in use

Refer to P154 for detailed specifications.



W Rubber wheel with steel plate wheel assembly (including B)
NR Rubber wheel with nylon wheel assembly (including B)
N Nylon wheel (including B)
GU Urethane wheel with nylon wheel assembly (including B)

J₂K-S TYPE

• Equipped with a pedal type single stopper
• Spirally fixing type



GUJ2K-150S

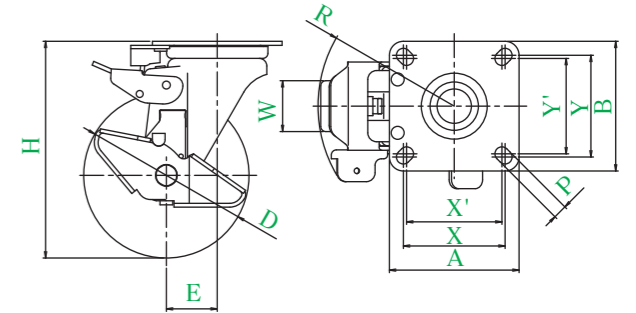

● Description of product number

GU J₂K - 150 S

Wheel type	Bracket type	Wheel diameter	Equipped with stopper
------------	--------------	----------------	-----------------------

Bracket = Trivalent unichrome coating

Product number	Wheels	Wheel diameter	Wheel width	Mounting height	Mounting base	Mounting dimensions	Hole diameter	Eccentricity	Turning radius	Allowance load	Wheel weight
		D(mm)	W(mm)	H(mm)	A × B(mm)	X × Y (X' × Y') (mm)	P(mm)	E(mm)	R(mm)	daN(kgf)	(g)
W NR N GU	Rubber wheel with steel plate wheel assembly (including B)	130	40	170	102 × 102	80 × 80 (75 × 75)	11	40	110	160(163.2)	2095
	Rubber wheel with nylon wheel assembly (including B)									160(163.2)	1650
	Nylon wheel (including B)									150(153.0)	1600
	Urethane wheel with nylon wheel assembly (including B)									160(163.2)	1630
W NR N GU	Rubber wheel with steel plate wheel assembly (including B)	150	40	190	102 × 102	80 × 80 (75 × 75)	11	40	115	180(183.6)	2085
	Rubber wheel with nylon wheel assembly (including B)									180(183.6)	1810
	Nylon wheel (including B)									160(163.2)	1745
	Urethane wheel with nylon wheel assembly (including B)									180(183.6)	1870

- This is a caster manufactured by providing the wheel lock function to J2K type. Each caster can be used independently.
- Swivel and fixed wheel can be switched with one touch operation.
- The rubber wheel with conductive steel plate wheel assembly (including B) having wheel diameter of φ 150 can be manufactured.

☆ Utility Model No.3014588

Wheel in use

Refer to P154 for detailed specifications.



W Rubber wheel with steel plate wheel assembly (including B)
NR Rubber wheel with nylon wheel assembly (including B)
N Nylon wheel (including B)
GU Urethane wheel with nylon wheel assembly (including B)

RJ₂ TYPE

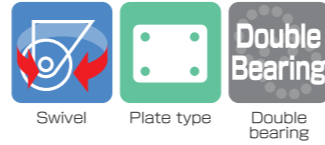

RJ2-150NWR

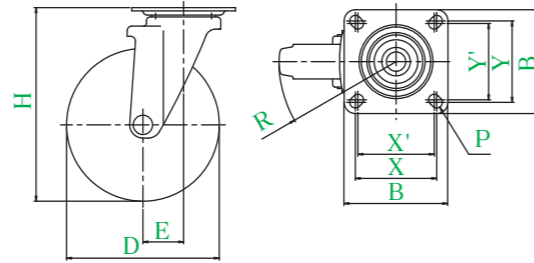

● Description of product number

RJ₂ - 150 NWR

Bracket type	Wheel diameter	Wheel type
--------------	----------------	------------

Bracket = Trivalent unichrome coating

Product number	Wheels										
		Wheel diameter D(mm)	Wheel width W(mm)	Mounting height H(mm)	Mounting base A × B(mm)	Mounting dimensions X × Y (X' × Y') (mm)	Hole diameter P(mm)	Eccentricity E(mm)	Turning radius R(mm)	Allowance load daN(kgf)	Wheel weight (g)
RJ2-150NWR	Rubber wheel with nylon wheel assembly (including B)	150	34	190	102 × 102	80 × 80 (75 × 75)	11	40	115	160(163.2)	1180

Wheel in use

Refer to P154 for detailed specifications.



NWR

Rubber wheel with nylon wheel assembly (including B)

RJ₂-S TYPE

● Equipped with a pedal type single stopper

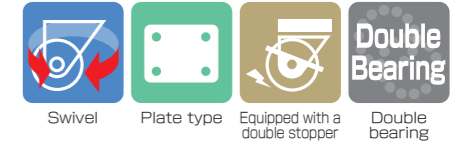

RJ2-150NWR S

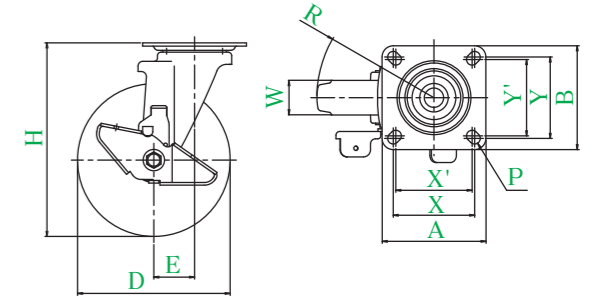

● Description of product number

RJ₂ - 150 NWR S

Bracket type	Wheel diameter	Wheel type	Equipped with stopper
--------------	----------------	------------	-----------------------

Bracket = Trivalent unichrome coating

Product number	Wheels										
		Wheel diameter D(mm)	Wheel width W(mm)	Mounting height H(mm)	Mounting base A × B(mm)	Mounting dimensions X × Y (X' × Y') (mm)	Hole diameter P(mm)	Eccentricity E(mm)	Turning radius R(mm)	Allowance load daN(kgf)	Wheel weight (g)
RJ2-150NWR S	Rubber wheel with nylon wheel assembly (including B)	150	34	190	102 × 102	80 × 80 (75 × 75)	11	40	115	160(163.2)	1340

● These casters are used for only locking rotation of the wheel.

Wheel in use

Refer to P154 for detailed specifications.



NWR

Rubber wheel with nylon wheel assembly (including B)

K₂ TYPE

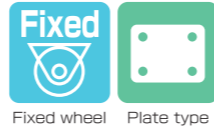

NWRK2-150

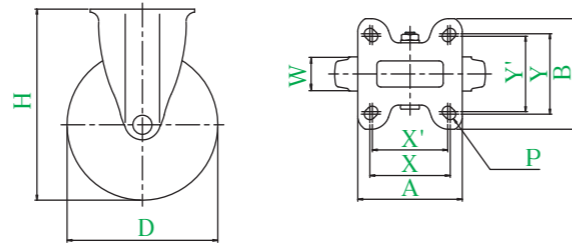

● Description of product number

NWR K₂ - 150

Wheel type	Bracket type	Wheel diameter
------------	--------------	----------------

Bracket = Trivalent unichrome coating

Product number	Wheels								
		Wheel diameter D(mm)	Wheel width W(mm)	Mounting height H(mm)	Mounting base A × B(mm)	Mounting dimensions X × Y(mm)	Hole diameter P(mm)	Allowance load daN(kgf)	Wheel weight (g)
NWR K2-150	Rubber wheel with nylon wheel assembly (including B)	150	34	190	104 × 110	80 × 80 (75 × 75)	11	160(163.2)	1115

Wheel in use

Refer to P154 for detailed specifications.



NWR
Rubber wheel with nylon wheel assembly (including B)

SJTYPE



There are some non-conforming products.

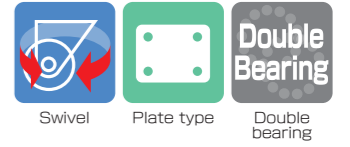

SJ-100W

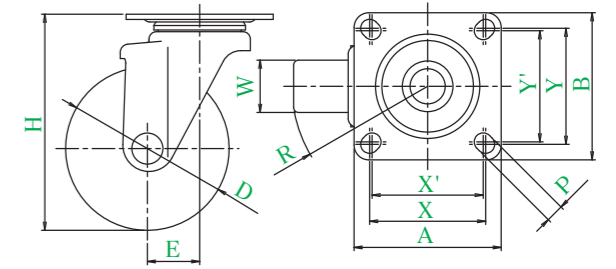

● Description of product number

SJ - 100 W

Bracket type	Wheel diameter	Wheel type
--------------	----------------	------------

Bracket = Trivalent unichrome coating

Product number	Wheels										
		Wheel diameter D(mm)	Wheel width W(mm)	Mounting height H(mm)	Mounting base A × B(mm)	Mounting dimensions X × Y (X' × Y') (mm)	Hole diameter P(mm)	Eccentricity E(mm)	Turning radius R(mm)	Allowance load daN(kgf)	Wheel weight (g)
SJ-100	W Rubber wheel with steel plate wheel assembly (including B)	100	32	132	90 × 90	71 × 71 (68 × 68)	11	32	82	120(122.4)	980
	WP Rubber wheel with steel plate wheel assembly									120(122.4)	930
	NR Rubber wheel with nylon wheel assembly (including B)									100(102.0)	870
	N Nylon wheel									120(122.4)	780
	NB Nylon wheel (including B)									120(122.4)	870
	UW Urethane wheel with steel plate wheel assembly (including B)									120(122.4)	1070
SJ-125	W Rubber wheel with steel plate wheel assembly (including B)	125	32	168	102 × 102	80 × 80 (75 × 75)	11	32	95	120(122.4)	1180
	WP Rubber wheel with steel plate wheel assembly									120(122.4)	1130
	GU Urethane wheel with nylon wheel assembly (including B)									120(122.4)	1055

● The rubber wheel with conductive steel plate wheel assembly (including B) and the urethane wheel with antistatic steel plate wheel assembly (including B) having wheel diameter of φ 100 can be manufactured.

Wheel in use

Refer to P154 for detailed specifications.

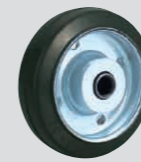

W
Rubber wheel with steel plate wheel assembly (including B)



WP
Rubber wheel with steel plate wheel assembly



NR
Rubber wheel with nylon wheel assembly (including B)



N
Nylon wheel



NB
Nylon wheel (including B)

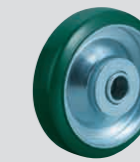

UW
Urethane wheel with steel plate wheel assembly (including B)



GU
Urethane wheel with nylon wheel assembly (including B)

SJ-S TYPE



There are some non-conforming products.

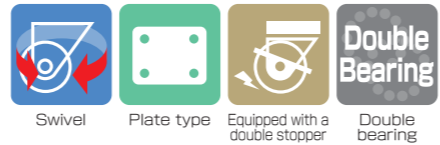

• Equipped with a pedal type single stopper



SJ-100WS

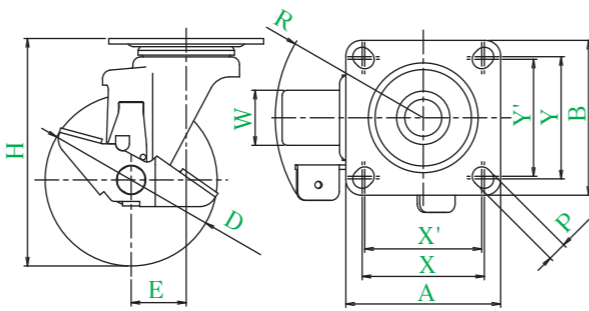

● Description of product number

SJ - 100 W S

Bracket type
Wheel diameter
Equipped with stopper
Wheel type

Bracket = Trivalent unichrome coating

Product number	Wheels	Wheel diameter	Wheel width	Mounting height	Mounting base	Mounting dimensions	Hole diameter	Eccentricity	Turning radius	Allowance load	Wheel weight
		D(mm)	W(mm)	H(mm)	A × B(mm)	X × Y(X' × Y') (mm)	P(mm)	E(mm)	R(mm)	daN(kgf)	(g)
SJ-100	W	100	32	132	90 × 90	71 × 71 (68 × 68)	11	32	86	120(122.4)	1080
	WP									120(122.4)	1020
	NR									100(102.0)	970
	N									120(122.4)	860
	NB									120(122.4)	950
	UW									120(122.4)	1170
	GU									100(102.0)	970
SJ-125	W	125	32	168	102 × 102	80 × 80 (75 × 75)	11	32	97	120(122.4)	1300
	WP									120(122.4)	1250
	GU									120(122.4)	1250

- These casters are used for only locking rotation of the wheel.
- The rubber wheel with conductive steel plate wheel assembly (including B) and the urethane wheel with antistatic steel plate wheel assembly (including B) having wheel diameter of φ 100 can be manufactured.

Wheel in use Refer to P154 for detailed specifications.



SK TYPE



There are some non-conforming products.

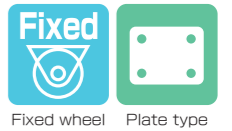

SK-100GU

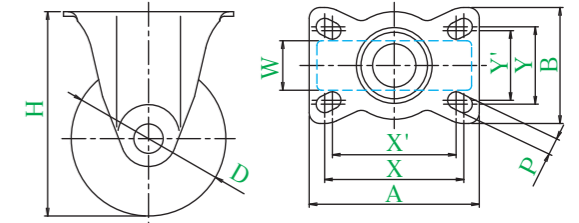

● Description of product number

SK - 100 GU

Bracket type
Wheel diameter
Wheel type

Bracket = Trivalent unichrome coating

Product number	Wheels	Wheel diameter	Wheel width	Mounting height	Mounting base	Mounting dimensions	Hole diameter	Allowance load	Wheel weight
		D(mm)	W(mm)	H(mm)	A × B(mm)	X × Y(X' × Y') (mm)	P(mm)	daN(kgf)	(g)
SK-100	W	100	32	132	110 × 75	90 × 50 (80 × 45)	11	120(122.4)	760
	WP							120(122.4)	710
	NR							100(102.0)	650
	N							120(122.4)	560
	NB							120(122.4)	685
	UW							120(122.4)	850
	GU							100(102.0)	680
SK-125	W	125	32	168	104 × 110	80 × 80 (75 × 75)	11	120(122.4)	1120
	WP							120(122.4)	1070
	GU							120(122.4)	960

- The rubber wheel with conductive steel plate wheel assembly (including B) and the urethane wheel with antistatic steel plate wheel assembly (including B) having wheel diameter of φ 100 can be manufactured.

Wheel in use Refer to P154 for detailed specifications.



SJT TYPE



There are some non-conforming products.



SJT-125W, M20×40

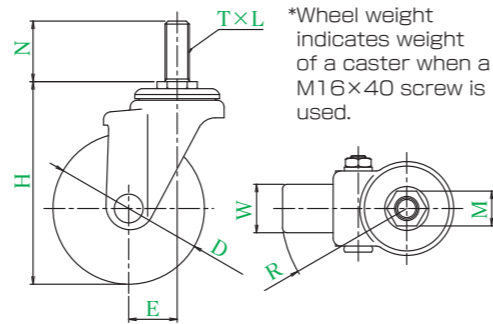

*Wheel weight indicates weight of a castor when a M16×40 screw is used.

● Description of product number
Please specify screw type and length.

SJT - 125 W , M20 × 40

Bracket type	Wheel diameter	Wheel type	Screw	Length
--------------	----------------	------------	-------	--------

Bracket = Trivalent unichrome coating

Product number	Wheels	Wheel diameter	Wheel width	Mounting height	Screw	Pitch	Length	Opposite side	Eccentricity	Turning radius	Allowance load	Wheel weight
		D(mm)	W(mm)	H(mm)	T	L	N(mm)	M(mm)	E(mm)	R(mm)	daN(kgf)	(g)
SJT-100	W	100	32	134	M16	2	40	23	32	82	120(122.4)	890
	WP										120(122.4)	930
	NR										100(102.0)	820
	N										120(122.4)	690
	NB										120(122.4)	745
	UW										120(122.4)	980
SJT-125	W	125	32	166	M16	2	40	23	32	95	120(122.4)	1040
	WP										120(122.4)	990
	NR										100(102.0)	860
	N										120(122.4)	780
	NB										120(122.4)	830
	UW										120(122.4)	1130

- For casters having wheel diameter of φ 100, there are types in which mounting height is 138mm.
- The rubber wheel with conductive steel plate wheel assembly (including B) and the urethane wheel with antistatic steel plate wheel assembly (including B) having wheel diameter of φ 100 can be manufactured.
- Allowable load is the allowable load when the stem is screwed in to the end.
- ★ Refer to P7 for the mounting method.

Wheel in use Refer to P154 for detailed specifications.



SJT-S TYPE



There are some non-conforming products.



● Equipped with a pedal type single stopper



SJT-125WS, M20×40

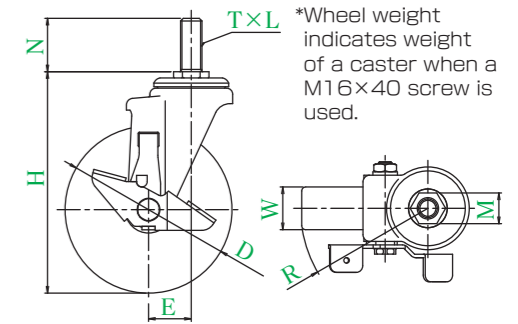

*Wheel weight indicates weight of a castor when a M16×40 screw is used.

● Description of product number
Please specify screw type and length.

SJT - 125 W S, M20 × 40

Bracket type	Wheel diameter	Wheel type	Equipped with stopper	Screw	Length
--------------	----------------	------------	-----------------------	-------	--------

Bracket = Trivalent unichrome coating

Product number	Wheels	Wheel diameter	Wheel width	Mounting height	Screw	Pitch	Length	Opposite side	Eccentricity	Turning radius	Allowance load	Wheel weight
		D(mm)	W(mm)	H(mm)	T	L	N(mm)	M(mm)	E(mm)	R(mm)	daN(kgf)	(g)
SJT-100	W	100	32	134	M16	2	40	23	32	86	120(122.4)	980
	WP										120(122.4)	1110
	NR										100(102.0)	1000
	N										120(122.4)	780
	NB										120(122.4)	830
	UW										120(122.4)	1130
SJT-125	W	125	32	166	M16	2	40	23	32	97	120(122.4)	1130
	WP										120(122.4)	1080
	NR										100(102.0)	860
	N										120(122.4)	780
	NB										120(122.4)	830
	UW										120(122.4)	1130

- These casters are used for only locking rotation of the wheel.
- For casters having wheel diameter of φ 100, there are types in which mounting height is 138mm.
- The rubber wheel with conductive steel plate wheel assembly (including B) and the urethane wheel with antistatic steel plate wheel assembly (including B) having wheel diameter of φ 100 can be manufactured.
- Allowable load is the allowable load when the stem is screwed in to the end.
- ★ Refer to P7 for the mounting method.

Wheel in use Refer to P154 for detailed specifications.

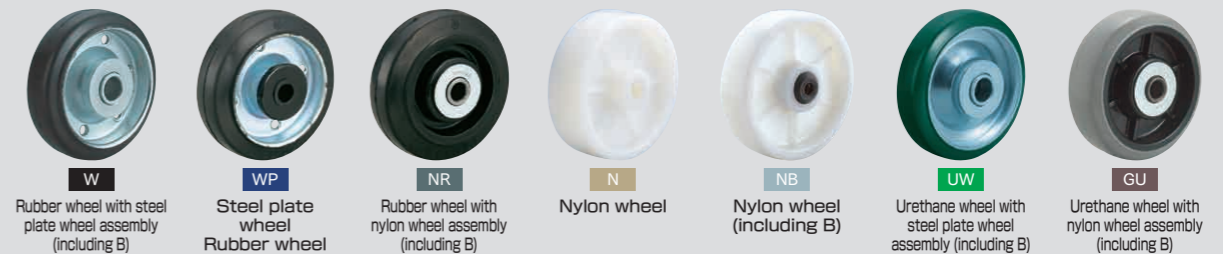

SJT-SW TYPE

• Equipped with a pedal type double stopper



SJT-125WSW, M20x40

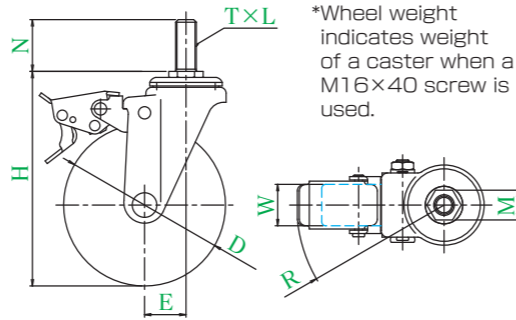
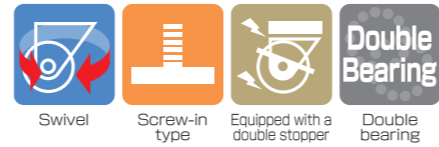

*Wheel weight indicates weight of a caster when a M16x40 screw is used.

● Description of product number
Please specify screw type and length.

SJT - 125 W SW, M20 x 40

Bracket type	Wheel diameter	Wheel type	Equipped with a double stopper	Screw	Length
--------------	----------------	------------	--------------------------------	-------	--------

Bracket = Trivalent unichrome coating

Product number	Wheels	Wheel diameter	Wheel width	Mounting height	Screw	Pitch	Length	Opposite side	Eccentricity	Turning radius	Allowance load	Wheel weight
		D(mm)	W(mm)	H(mm)	T	L	N(mm)	M(mm)	E(mm)	R(mm)	daN(kgf)	(g)
SJT-125	W	125	32	166	M16	2	40	23	32	114	120(122.4)	1240
	WP										120(122.4)	1165
	GU										120(122.4)	1085

- This caster is equipped with the double stopper that can lock the mounting portion and wheel.
- Casters having wheel diameter of $\phi 100$ can be manufactured. (Mounting height: 138mm)
- The rubber wheel with conductive steel plate wheel assembly (including B) and the urethane wheel with antistatic steel plate wheel assembly (including B) having wheel diameter of $\phi 100$ can be manufactured.
- Allowable load is the allowable load when the stem is screwed in to the end.
- ★ Refer to P7 for the mounting method.

Wheel in use Refer to P154 for detailed specifications.



W Rubber wheel with steel plate wheel assembly (including B)
WP Steel plate wheel Rubber wheel
GU Urethane wheel with nylon wheel assembly (including B)

SG TYPE



There are some non-conforming products.

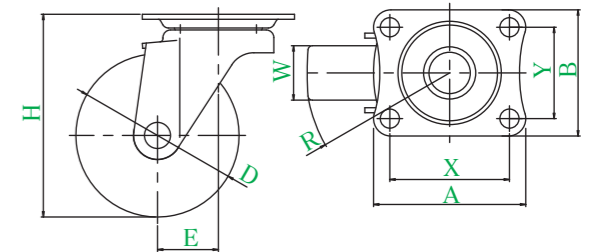
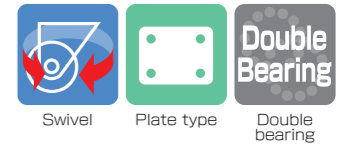

SG-75N

● Description of product number

SG - 75 N

Bracket type	Wheel diameter	Wheel type
--------------	----------------	------------

Bracket = Trivalent unichrome coating

Product number	Wheels	Wheel diameter	Wheel width	Mounting height	Mounting base	Mounting dimensions	Hole diameter	Eccentricity	Turning radius	Allowance load	Wheel weight
		D(mm)	W(mm)	H(mm)	A x B(mm)	X x Y(mm)	P(mm)	E(mm)	R(mm)	daN(kgf)	(g)
SG-50	RH	50	28	70	70 x 58	55 x 42	8.8	27	53	50(51.0)	300
	N									60(61.2)	265
	UR									60(61.2)	275
SG-65	RH	65	25	85	70 x 58	55 x 42	8.8	27	61	50(51.0)	350
	N									70(71.4)	285
	UR									60(61.2)	310
	EL									40(40.8)	310
SG-75	RH	75	25	93	70 x 58	55 x 42	8.8	28	66	60(61.2)	390
	NR									60(61.2)	320
	NRB									60(61.2)	360
	N									80(81.6)	300
	UR									70(71.4)	330
	UHF									70(71.4)	360
SG-100	RH	100	25	122	100 x 58	82 x 40	8.8	31	82	50(51.0)	550
	NR									60(61.2)	460
	NRB									60(61.2)	500
	N									60(61.2)	390
	UR									60(61.2)	425
	UHF									60(61.2)	470
EL	50(51.0)	430									

- For nylon wheels, black wheels can be manufactured.
- Conductive rubber wheel having wheel diameter of $\phi 75$ to $\phi 100$ can be manufactured.
- The antistatic urethane wheel having wheel diameter of $\phi 100$ can be manufactured.

Wheel in use Refer to P155 for detailed specifications.



RH Rubber wheel
NR Rubber wheel with nylon wheel assembly
NRB Rubber wheel with nylon wheel assembly (including B)
N Nylon wheel
UR Urethane wheel with nylon wheel assembly
UHF Urethane wheel with nylon wheel assembly (including B)
EL Elastomer wheel