

SJT-SW TYPE

• Equipped with a pedal type double stopper

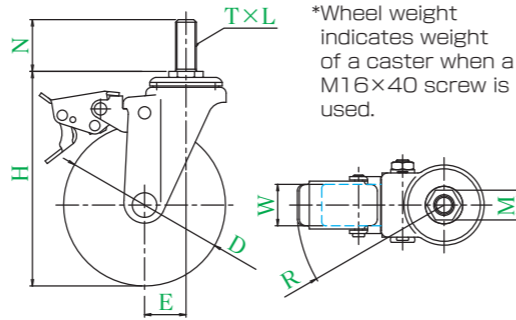

SJT-125WSW, M20x40

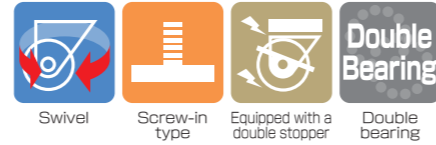

*Wheel weight indicates weight of a caster when a M16x40 screw is used.

● Description of product number
Please specify screw type and length.

SJT - 125 W SW, M20 x 40

Bracket type	Wheel diameter	Wheel type	Equipped with a double stopper	Screw	Length
--------------	----------------	------------	--------------------------------	-------	--------

Bracket = Trivalent unichrome coating

Product number	Wheels	Wheel diameter	Wheel width	Mounting height	Screw	Pitch	Length	Opposite side	Eccentricity	Turning radius	Allowance load	Wheel weight
		D(mm)	W(mm)	H(mm)	T	L	N(mm)	M(mm)	E(mm)	R(mm)	daN(kgf)	(g)
SJT-125	W	125	32	166	M16	2	40	23	32	114	120(122.4)	1240
	WP										120(122.4)	1165
	GU										120(122.4)	1085

- This caster is equipped with the double stopper that can lock the mounting portion and wheel.
- Casters having wheel diameter of φ 100 can be manufactured. (Mounting height: 138mm)
- The rubber wheel with conductive steel plate wheel assembly (including B) and the urethane wheel with antistatic steel plate wheel assembly (including B) having wheel diameter of φ 100 can be manufactured.
- Allowable load is the allowable load when the stem is screwed in to the end.
- ★ Refer to P7 for the mounting method.

Wheel in use Refer to P154 for detailed specifications.



W Rubber wheel with steel plate wheel assembly (including B)
WP Steel plate wheel Rubber wheel
GU Urethane wheel with nylon wheel assembly (including B)

SG TYPE



There are some non-conforming products.

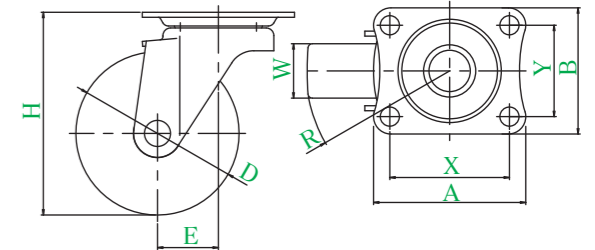
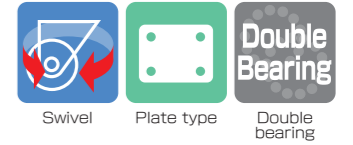

SG-75N

● Description of product number

SG - 75 N

Bracket type	Wheel diameter	Wheel type
--------------	----------------	------------

Bracket = Trivalent unichrome coating

Product number	Wheels	Wheel diameter	Wheel width	Mounting height	Mounting base	Mounting dimensions	Hole diameter	Eccentricity	Turning radius	Allowance load	Wheel weight
		D(mm)	W(mm)	H(mm)	A x B(mm)	X x Y(mm)	P(mm)	E(mm)	R(mm)	daN(kgf)	(g)
SG-50	RH	50	28	70	70 x 58	55 x 42	8.8	27	53	50(51.0)	300
	N		25							60(61.2)	265
	UR		25							60(61.2)	275
SG-65	RH	65	25	85	70 x 58	55 x 42	8.8	27	61	50(51.0)	350
	N		27							70(71.4)	285
	UR		27							60(61.2)	310
	EL		27							40(40.8)	310
SG-75	RH	75	25	93	70 x 58	55 x 42	8.8	28	66	60(61.2)	390
	NR		27							60(61.2)	320
	NRB		27							60(61.2)	360
	N		25							80(81.6)	300
	UR		26							70(71.4)	330
	UHF		26							70(71.4)	360
SG-100	RH	100	25	122	100 x 58	82 x 40	8.8	31	82	50(51.0)	550
	NR		27							60(61.2)	460
	NRB		27							60(61.2)	500
	N		25							60(61.2)	390
	UR		28							60(61.2)	425
	UHF		28							60(61.2)	470
EL	27	50(51.0)	430								

- For nylon wheels, black wheels can be manufactured.
- Conductive rubber wheel having wheel diameter of φ 75 to φ 100 can be manufactured.
- The antistatic urethane wheel having wheel diameter of φ 100 can be manufactured.

Wheel in use Refer to P155 for detailed specifications.



RH Rubber wheel
NR Rubber wheel with nylon wheel assembly
NRB Rubber wheel with nylon wheel assembly (including B)
N Nylon wheel
UR Urethane wheel with nylon wheel assembly
UHF Urethane wheel with nylon wheel assembly (including B)
EL Elastomer wheel

SG-S TYPE



There are some non-conforming products.

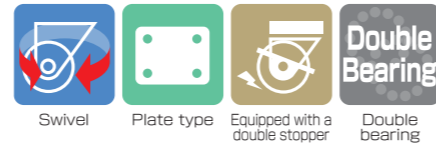

• Equipped with a pedal type single stopper



SG-75NS



SG-75UHFD

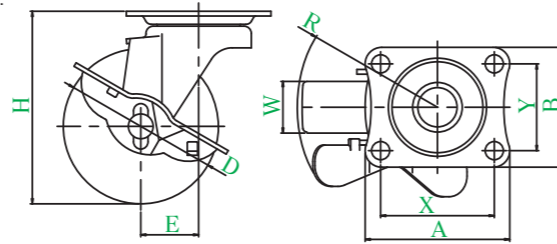

● Description of product number

SG - 75 N S

Bracket type
Wheel diameter
Wheel type
Equipped with stopper

(* "S" indicates that a stopper is equipped. If wheel type is NRB or UHF, please describe "DS".)

Bracket = Trivalent unichrome coating

Product number	Wheels	Wheel diameter	Wheel width	Mounting height	Mounting base	Mounting dimensions	Hole diameter	Eccentricity	Turning radius	Allowance load	Wheel weight
		D(mm)	W(mm)	H(mm)	A × B(mm)	X × Y(mm)	P(mm)	E(mm)	R(mm)	daN(kgf)	(g)
SG-50	RH Rubber wheel	50	28	70	70 × 58	55 × 42	8.8	27	67	50(51.0)	330
	N Nylon wheel									60(61.2)	305
	UR Urethane wheel with nylon wheel assembly									60(61.2)	310
SG-65	RH Rubber wheel	65	25	85	70 × 58	55 × 42	8.8	27	68	50(51.0)	400
	N Nylon wheel									70(71.4)	330
	UR Urethane wheel with nylon wheel assembly									60(61.2)	355
	EL Elastomer wheel									40(40.8)	360
SG-75	RH Rubber wheel	75	25	93	70 × 58	55 × 42	8.8	28	68	60(61.2)	440
	NR Rubber wheel with nylon wheel assembly									60(61.2)	385
	NRB Rubber wheel with nylon wheel assembly (including B)									60(61.2)	425
	N Nylon wheel									80(81.6)	345
	UR Urethane wheel with nylon wheel assembly									70(71.4)	370
	UHF Urethane wheel with nylon wheel assembly (including B)									70(71.4)	420
	EL Elastomer wheel									50(51.0)	380
SG-100	RH Rubber wheel	100	25	122	100 × 58	82 × 40	8.8	31	82	50(51.0)	610
	NR Rubber wheel with nylon wheel assembly									60(61.2)	520
	NRB Rubber wheel with nylon wheel assembly (including B)									60(61.2)	560
	N Nylon wheel									60(61.2)	455
	UR Urethane wheel with nylon wheel assembly									60(61.2)	490
	UHF Urethane wheel with nylon wheel assembly (including B)									60(61.2)	510
	EL Elastomer wheel									50(51.0)	490

- These castors are used for only locking rotation of the wheel.
- Conductive rubber wheel having wheel diameter of φ 75 to φ 100 can be manufactured.
- For nylon wheels, black wheels can be manufactured.
- The antistatic urethane wheel having wheel diameter of φ 100 can be manufactured.

Wheel in use

Refer to P155 for detailed specifications.



SR TYPE



There are some non-conforming products.

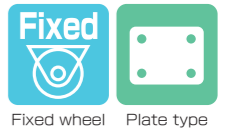

SR-100RH

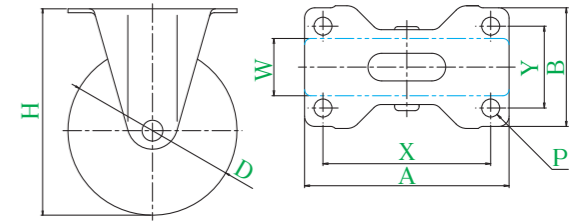

● Description of product number

SR - 100 RH

Bracket type
Wheel diameter
Wheel type

Bracket = Trivalent unichrome coating

Product number	Wheels	Wheel diameter	Wheel width	Mounting height	Mounting base	Mounting dimensions	Hole diameter	Allowance load	Wheel weight
		D(mm)	W(mm)	H(mm)	A × B(mm)	X × Y(mm)	P(mm)	daN(kgf)	(g)
SR-50	RH Rubber wheel	50	28	70	70 × 47	55 × 28	8.8	50(51.0)	190
	N Nylon wheel							60(61.2)	160
	UR Urethane wheel with nylon wheel assembly							60(61.2)	165
SR-65	RH Rubber wheel	65	25	85	70 × 47	55 × 28	8.8	50(51.0)	240
	N Nylon wheel							70(71.4)	180
	UR Urethane wheel with nylon wheel assembly							60(61.2)	205
	EL Elastomer wheel							40(40.8)	200
SR-75	RH Rubber wheel	75	25	93	70 × 47	55 × 28	8.8	60(61.2)	280
	NR Rubber wheel with nylon wheel assembly							60(61.2)	215
	NRB Rubber wheel with nylon wheel assembly (including B)							60(61.2)	255
	N Nylon wheel							80(81.6)	195
	UR Urethane wheel with nylon wheel assembly							70(71.4)	220
	UHF Urethane wheel with nylon wheel assembly (including B)							70(71.4)	230
	EL Elastomer wheel							50(51.0)	220
SR-100	RH Rubber wheel	100	25	122	100 × 58	82 × 40	8.8	50(51.0)	480
	NR Rubber wheel with nylon wheel assembly							60(61.2)	395
	NRB Rubber wheel with nylon wheel assembly (including B)							60(61.2)	435
	N Nylon wheel							60(61.2)	325
	UR Urethane wheel with nylon wheel assembly							60(61.2)	365
	UHF Urethane wheel with nylon wheel assembly (including B)							60(61.2)	405
	EL Elastomer wheel							50(51.0)	360

- For nylon wheels, black wheels can be manufactured.
- Conductive rubber wheel having wheel diameter of φ 75 to φ 100 can be manufactured.
- The antistatic urethane wheel having wheel diameter of φ 100 can be manufactured.

Wheel in use

Refer to P155 for detailed specifications.



SGR TYPE



There are some non-conforming products.

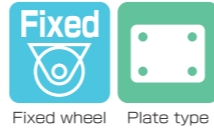

Fixed wheel Plate type



SGR-75UR(P55 x 42)-90

● Description of product number
Please specify degrees.

SGR - 75 UR (P55 x 42)- 90, 45R or 45L

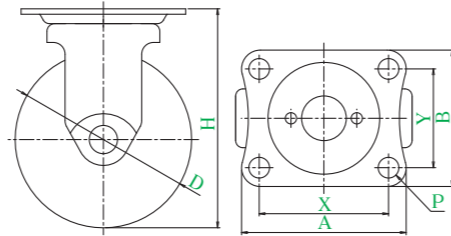
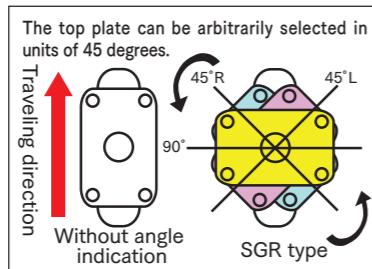
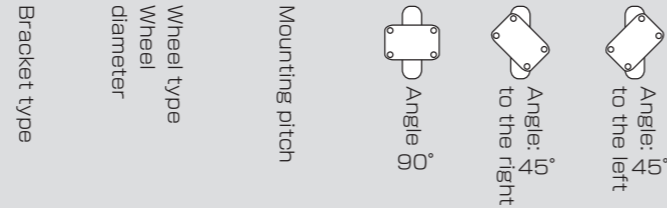

Bracket = Trivalent unichrome coating

Product number	Wheels	Wheel diameter	Wheel width	Mounting height	Mounting base	Mounting dimensions	Hole diameter	Allowance load	Wheel weight
		D(mm)	W(mm)	H(mm)	A x B(mm)	X x Y(mm)	P(mm)	daN(kgf)	(g)
SGR-75	RH Rubber wheel	75	25	93	70 x 58	55 x 42	8.8	60(61.2)	290
	NR Rubber wheel with nylon wheel assembly		27					60(61.2)	230
	NRB Rubber wheel with nylon wheel assembly (including B)		25					60(61.2)	265
	N Nylon wheel		25					80(81.6)	195
	UR Urethane wheel with nylon wheel assembly		26					70(71.4)	215
	UHF Urethane wheel with nylon wheel assembly (including B)		27					50(51.0)	220
SGR-100	RH Rubber wheel	100	25	122	70 x 58	55 x 42	8.8	50(51.0)	500
	NR Rubber wheel with nylon wheel assembly		27					60(61.2)	435
	NRB Rubber wheel with nylon wheel assembly (including B)		25					60(61.2)	470
	N Nylon wheel		25					60(61.2)	320
	UR Urethane wheel with nylon wheel assembly		28					60(61.2)	355
	UHF Urethane wheel with nylon wheel assembly (including B)		27					60(61.2)	455
	EL Elastomer wheel		27				50(51.0)	340	

- For nylon wheels, black wheels can be manufactured.
- Conductive rubber wheel can be manufactured.
- For casters having wheel diameter of $\phi 100$, the antistatic urethane wheel can be manufactured.

SG type and SR type can be shared.

☆ Patent Pending No.2010-083458

Wheel in use Refer to P155 for detailed specifications.



SGC TYPE



There are some non-conforming products.

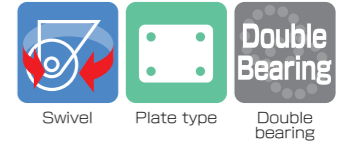

Swivel Plate type Double bearing



SGC-75RH, $\phi 8.8$

● Description of product number

SGC - 75 RH and $\phi 8.8$

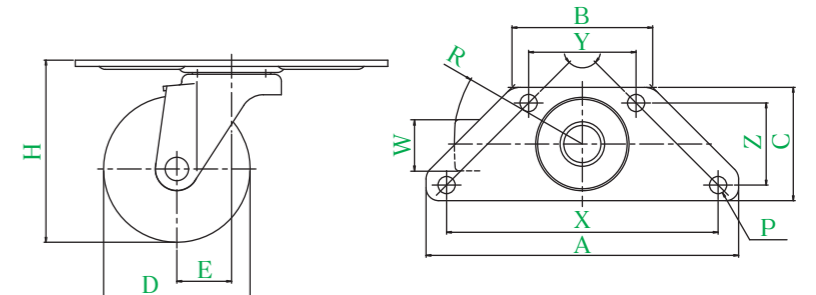
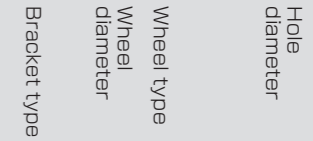

Bracket = Trivalent unichrome coating

Product number	Wheels	Wheel diameter	Wheel width	Mounting height	Mounting base	Mounting dimensions	Hole diameter	Eccentricity	Turning radius	Allowance load	Wheel weight
		D(mm)	W(mm)	H(mm)	A x B x C (mm)	X x Y x Z (mm)	P(mm)	E(mm)	R(mm)	daN(kgf)	(g)
SGC-50	RH Rubber wheel	50	28	70	160 x 72 x 58	139 x 55 x 42	8.8	27	53	50(51.0)	405
	N Nylon wheel									60(61.2)	370
	UR Urethane wheel with nylon wheel assembly		25							60(61.2)	380
SGC-65	RH Rubber wheel	65	25	85	160 x 72 x 58	139 x 55 x 42	8.8	27	60	50(51.0)	445
	N Nylon wheel									70(71.4)	390
	UR Urethane wheel with nylon wheel assembly		26							60(61.2)	415
	EL Elastomer wheel		27							40(40.8)	415
SGC-75	RH Rubber wheel	75	25	93	160 x 72 x 58	139 x 55 x 42	8.8	28	66	60(61.2)	495
	NR Rubber wheel with nylon wheel assembly		27							60(61.2)	425
	NRB Rubber wheel with nylon wheel assembly (including B)		25							60(61.2)	465
	N Nylon wheel		25							80(81.6)	410
	UR Urethane wheel with nylon wheel assembly		26							70(71.4)	435
	UHF Urethane wheel with nylon wheel assembly (including B)		27							70(71.4)	465
	EL Elastomer wheel		27							50(51.0)	435

- For nylon wheels, black wheels can be manufactured.
- Conductive rubber wheel having wheel diameter of $\phi 75$ to $\phi 100$ can be manufactured.
- The antistatic urethane wheel having wheel diameter of $\phi 100$ can be manufactured.

Wheel in use Refer to P155 for detailed specifications.



SGC-S TYPE



There are some non-conforming products.



Swivel



Plate type



Equipped with a double stopper



Double bearing

• Equipped with a pedal type single stopper

● Description of product number
SGC - 75 N S, φ 8.8

Bracket type	Wheel diameter	Equipped with stopper type	Hole diameter
--------------	----------------	----------------------------	---------------

(* "S" indicates that a stopper is equipped. If wheel type is NRB or UHF, please describe "DS".)

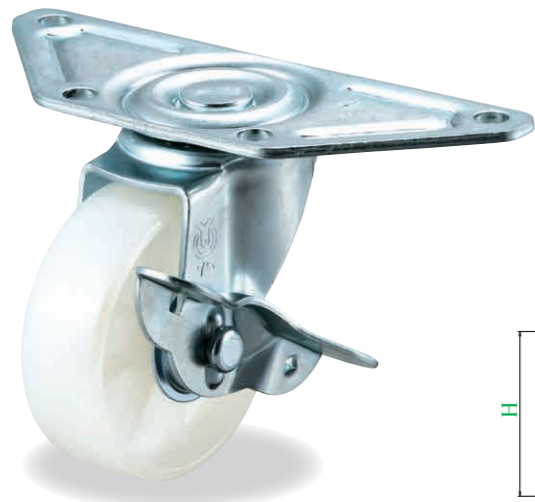

SGC-75NS, φ 8.8

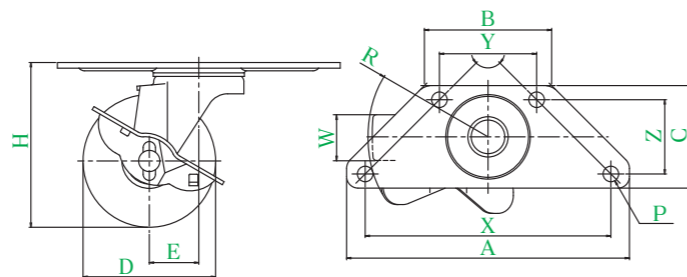

Bracket = Trivalent unichrome coating

Product number	Wheels	Wheel diameter	Wheel width	Mounting height	Mounting base	Mounting dimensions	Hole diameter	Eccentricity	Turning radius	Allowance load	Wheel weight
		D(mm)	W(mm)	H(mm)	A × B × C (mm)	X × Y × Z (mm)	P(mm)	E(mm)	R(mm)	daN(kgf)	(g)
SGC-50	RH φ 8.8 Rubber wheel	50	28	70	160 × 72 × 58	139 × 55 × 42	8.8	27	67	50(51.0)	440
	N Nylon wheel									60(61.2)	410
	UR Urethane wheel with nylon wheel assembly									60(61.2)	420
SGC-65	RH φ 8.8 Rubber wheel	65	25	85	160 × 72 × 58	139 × 55 × 42	8.8	27	68	50(51.0)	510
	N Nylon wheel									70(71.4)	440
	UR Urethane wheel with nylon wheel assembly									60(61.2)	460
	EL Elastomer wheel									40(40.8)	470
SGC-75	RH φ 8.8 Rubber wheel	75	25	93	160 × 72 × 58	139 × 55 × 42	8.8	28	68	60(61.2)	550
	NR Rubber wheel with nylon wheel assembly									60(61.2)	495
	NRB Rubber wheel with nylon wheel assembly (including B)									70	535
	N Nylon wheel									80(81.6)	457
	UR Urethane wheel with nylon wheel assembly									70	480
	UHF Urethane wheel with nylon wheel assembly (including B)									70	530
SGC-75	EL φ 8.8 Elastomer wheel	75	27	93	160 × 72 × 58	139 × 55 × 42	8.8	28	68	50(51.0)	490
	UR φ 8.8 Urethane wheel with nylon wheel assembly									70	480
	UHF φ 8.8 Urethane wheel with nylon wheel assembly (including B)									70	530
	EL φ 8.8 Elastomer wheel									68	490

- These casters are used for only locking rotation of the wheel.
- For nylon wheels, black wheels can be manufactured.
- Conductive rubber wheel having wheel diameter of φ 75 to φ 100 can be manufactured.
- The antistatic urethane wheel having wheel diameter of φ 100 can be manufactured.

Wheel in use

Refer to P155 for detailed specifications.



ST TYPE



There are some non-conforming products.



Swivel



Screw-in type



Double bearing



ST-75RH, UNF1/2 × 25

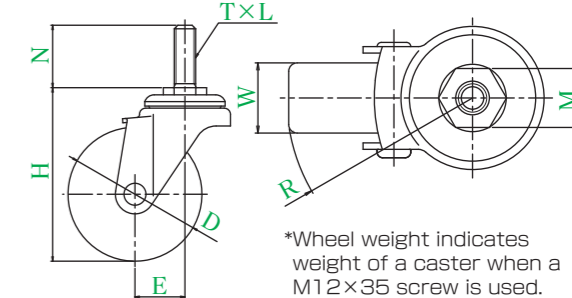

*Wheel weight indicates weight of a caster when a M12 × 35 screw is used.

● Description of product number
 Please specify screw type and length.

ST - 75 RH , UNF1/2 × 25

Bracket type	Wheel diameter	Wheel type	Screw	Length
--------------	----------------	------------	-------	--------

Bracket = Trivalent unichrome coating

Product number	Wheels	Wheel diameter	Wheel width	Mounting height	Screw	Pitch and threads Per inch	Length	Opposite side	Eccentricity	Turning radius	Allowance load	Wheel weight
		D(mm)	W(mm)	H(mm)	T	L	N(mm)	M(mm)	E(mm)	R(mm)	daN(kgf)	(g)
ST-50	RH Rubber wheel	50	28	74							50(51.0)	310
	N Nylon wheel										60(61.2)	265
	UR Urethane wheel with nylon wheel assembly										60(61.2)	290
ST-65	RH Rubber wheel	65	25	89							50(51.0)	360
	N Nylon wheel										70(71.4)	285
	UR Urethane wheel with nylon wheel assembly										60(61.2)	390
	EL Elastomer wheel										40(40.8)	320
ST-75	RH Rubber wheel	75	25	97							60(61.2)	400
	NR Rubber wheel with nylon wheel assembly										60(61.2)	330
	NRB Rubber wheel with nylon wheel assembly (including B)										60(61.2)	370
	N Nylon wheel										80(81.6)	315
	UR Urethane wheel with nylon wheel assembly										70(71.4)	340
	UHF Urethane wheel with nylon wheel assembly (including B)										70(71.4)	370
ST-100	RH Rubber wheel	100	25	126							50(51.0)	525
	NR Rubber wheel with nylon wheel assembly										60(61.2)	440
	NRB Rubber wheel with nylon wheel assembly (including B)										60(61.2)	480
	N Nylon wheel										60(61.2)	370
	UR Urethane wheel with nylon wheel assembly										60(61.2)	405
	UHF Urethane wheel with nylon wheel assembly (including B)										60(61.2)	495
ST-100	EL Elastomer wheel	50(51.0)	395									

- For nylon wheels, black wheels can be manufactured.
- Conductive rubber wheel having wheel diameter of φ 75 to φ 100 can be manufactured.
- The antistatic urethane wheel having wheel diameter of φ 100 can be manufactured.
- Some types of screws may not be in stock.
- Allowable load is the allowable load when the stem is screwed in to the end.
- ★ Refer to P7 for the mounting method.

Wheel in use

Refer to P155 for detailed specifications.



ST-S TYPE



There are some non-conforming products.

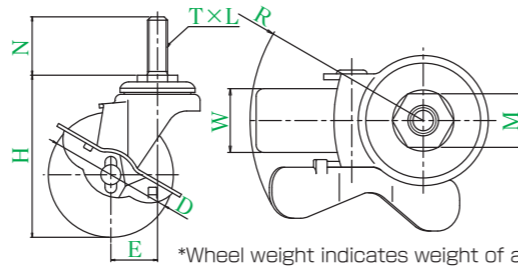
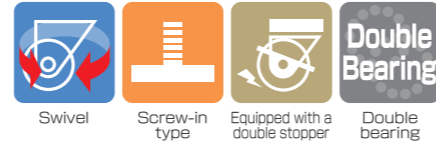

*Wheel weight indicates weight of a caster when a M12×35 screw is used.

• Equipped with a pedal type single stopper

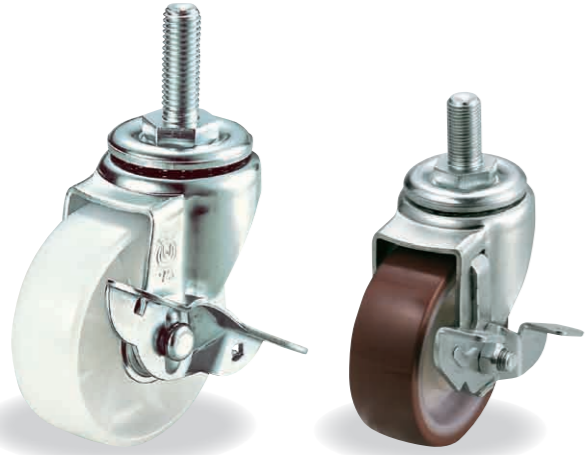

ST-75NS, M12×35 ST-75UHFD, UNF1/2×25

● Description of product number
Please specify screw type and length.

ST - 100 UR S , M16 × 40

Bracket type Wheel diameter Wheel type Equipped with stopper Screw Length
(* "S" indicates that a stopper is equipped. If wheel type is NRB or UHF, please describe "DS".)

Bracket = Trivalent unichrome coating

Product number	Wheels	Wheel diameter	Wheel width	Mounting height	Screw	Pitch and threads Per inch	Length	Opposite side	Eccentricity	Turning radius	Allowance load	Wheel weight
		D(mm)	W(mm)	H(mm)	T	L	N(mm)	M(mm)	E(mm)	R(mm)	daN(kgf)	(g)
ST-50	RH S Rubber wheel	50	28	74						27	50(51.0)	345
	N S Nylon wheel		25								60(61.2)	320
	UR S Urethane wheel with nylon wheel assembly										60(61.2)	325
ST-65	RH S Rubber wheel	65	25	89						27	50(51.0)	415
	N S Nylon wheel										70(71.4)	345
	UR S Urethane wheel with nylon wheel assembly										60(61.2)	370
	EL S Elastomer wheel		27								40(40.8)	
ST-75	RH S Rubber wheel	75	25	97	M12	1.75	35	21		28	60(61.2)	455
	NR S Rubber wheel with nylon wheel assembly		27								60(61.2)	400
	NRB DS Rubber wheel with nylon wheel assembly (including B)		27								60(61.2)	440
	N S Nylon wheel		25		80(81.6)	360						
	UR S Urethane wheel with nylon wheel assembly		26		70(71.4)	385						
	UHF DS Urethane wheel with nylon wheel assembly (including B)		26		70(71.4)	430						
	EL S Elastomer wheel	27	50(51.0)	385								
ST-100	RH S Rubber wheel	100	25	126						31	50(51.0)	600
	NR S Rubber wheel with nylon wheel assembly		27								60(61.2)	505
	NRB DS Rubber wheel with nylon wheel assembly (including B)		27								60(61.2)	510
	N S Nylon wheel		25								60(61.2)	435
	UR S Urethane wheel with nylon wheel assembly		28								60(61.2)	475
	UHF DS Urethane wheel with nylon wheel assembly (including B)		28								60(61.2)	525
	EL S Elastomer wheel	27	50(51.0)	460								

- These casters are used for only locking rotation of the wheel.
- Conductive rubber wheel having wheel diameter of φ 75 to φ 100 can be manufactured.
- Some types of screws may not be in stock.
- For nylon wheels, black wheels can be manufactured.
- The antistatic urethane wheel having wheel diameter of φ 100 can be manufactured.
- Allowable load is the allowable load when the stem is screwed in to the end.
- ★ Refer to P7 for the mounting method.

Wheel in use Refer to P155 for detailed specifications.



ST SPECIAL TYPE

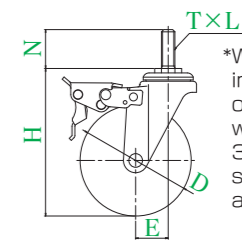
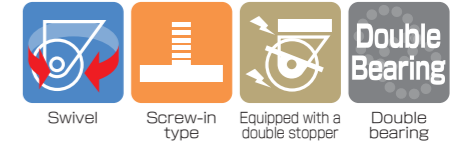

*Wheel weight indicates weight of a caster in which M12 x 35 screw and stopper type-1 are used.



ST-100NU(H132), M16×40 ST-100NUSW-1, M16×40 ST-100NUSW-2, M16×40 ST-100NUSW-3, M16×40

Bracket = Trivalent unichrome coating

Product number	Stopper	Wheels	Wheel diameter	Wheel width	Mounting height	Screw	Pitch	Length	Opposite side	Eccentricity	Turning radius	Allowance load	Wheel weight
			D(mm)	W(mm)	H(mm)	T	L	N(mm)	M(mm)	E(mm)	R(mm)	daN(kgf)	(g)
ST-75	-1	NRB(H104) Not available	75	25	104						65	70(71.4)	
		NRBSW Available									92(*1)	70(71.4)	
		NU(H104) Not available									65	70(71.4)	335
		NUSW Available									92(*1)	70(71.4)	490
		UHF(H104) Not available									65	70(71.4)	
		UHFSW Available									92(*1)	70(71.4)	
ST-100	-1	NRB(H132) Not available	100	25	132						80	70(71.4)	
		NRBSW Available									93(*2)	70(71.4)	
		NU(H132) Not available									80	70(71.4)	530
		NUSW Available									93(*2)	70(71.4)	600
		UHF(H132) Not available									80	70(71.4)	
		UHFSW Available									93(*2)	70(71.4)	

- *1 This is the turning radius of stopper type -1. As for -2, the turning radius increases for +12mm. As for -3, the turning radius increases for +4mm.
- *2 This is the turning radius of stopper type -1. As for -2, the turning radius increases for +2mm. As for -3, the turning radius increases for +4mm.
- * Be sure to wear shoes when operating the stopper.
- * If you operate the stopper by hand, you may get injured. Therefore, do not operate the stopper by hand.
- Allowable load is the allowable load when the stem is screwed in to the end.
- ★ Refer to P7 for the mounting method.

Wheel in use Refer to P155 for detailed specifications.



● Description of product number
Please specify screw type and length.

ST - 100 NU SW - 3 , M16 × 40

Bracket type Wheel diameter Wheel type Availability of a double stopper Stopper type* Screw Length
*Stopper type
-1: Resin stopper
-2: Resin stopper equipped with the release lever
-3: Steel plate stopper equipped with the release lever

STF_{TYPE}

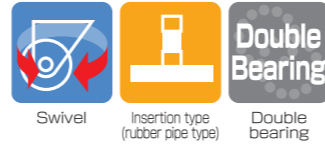

STF-75RH, ϕ 22

STF-75N, ϕ 24

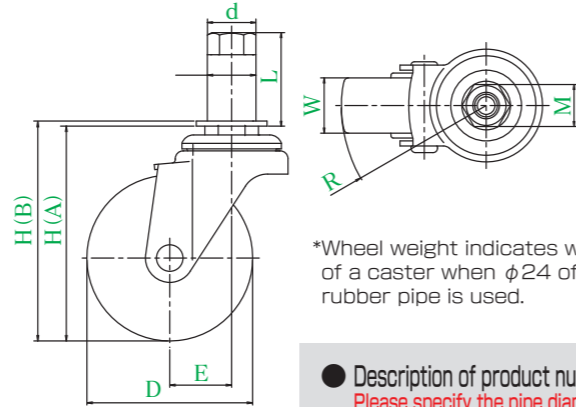

*Wheel weight indicates weight of a caster when ϕ 24 of rubber pipe is used.

● Description of product number
Please specify the pipe diameter.

STF - 75 RH , ϕ 22

Bracket type
Wheel diameter
Wheel type
Pipe diameter

Bracket = Trivalent unichrome coating

Product number	Wheels	Wheel diameter	Wheel width	Mounting height	Pipe diameter	Axis length	Opposite side	Eccentricity	Turning radius	Allowance load	Wheel weight	
		D(mm)	W(mm)	H(mm)	d(mm)	L(mm)	M(mm)	E(mm)	R(mm)	daN(kgf)	(g)	
STF-50	RH Rubber wheel	50	28	A=74 B=77					27	53	50(51.0)	350
	N Nylon wheel										60(61.2)	320
	UR Urethane wheel with nylon wheel assembly										60(61.2)	325
STF-65	RH Rubber wheel	65	25	A=89 B=92	22	40	21	27	61		50(51.0)	400
	N Nylon wheel										70(71.4)	340
	UR Urethane wheel with nylon wheel assembly										60(61.2)	365
	EL Elastomer wheel										40(40.8)	360
STF-75	RH Rubber wheel	75	25	A=97 B=100	34	60	21	28	66		60(61.2)	440
	NR Rubber wheel with nylon wheel assembly										60(61.2)	375
	NRB Rubber wheel with nylon wheel assembly (including B)										60(61.2)	410
	N Nylon wheel										70(71.4)	355
	UR Urethane wheel with nylon wheel assembly										70(71.4)	385
	UHF Urethane wheel with nylon wheel assembly (including B)										70(71.4)	410
EL Elastomer wheel	50(51.0)	380										

● For nylon wheels, black wheels can be manufactured.
★ Refer to P8 for the mounting method.

Wheel in use Refer to P155 for detailed specifications.



STF-S_{TYPE}

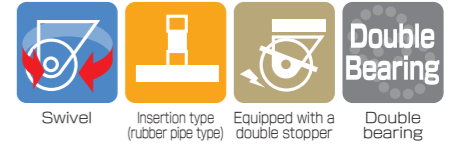

• Equipped with a pedal type single stopper



STF-75RHS, ϕ 22

STF-75N, ϕ 24

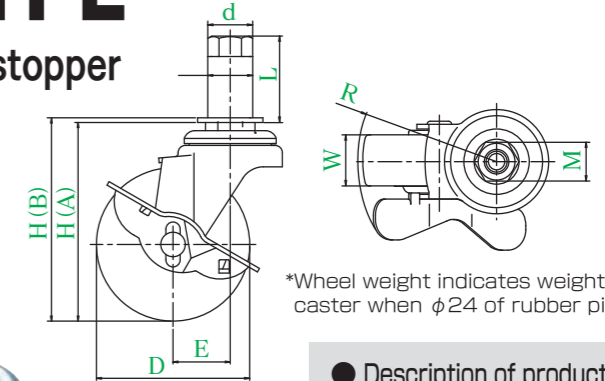

*Wheel weight indicates weight of a caster when ϕ 24 of rubber pipe is used.

● Description of product number
Please specify the pipe diameter.

STF - 75 RH S , ϕ 22

Bracket type
Wheel diameter
Wheel type
Equipped with stopper
Pipe diameter

(* 'S' indicates that a stopper is equipped. If wheel type is NRB or UHF, please describe 'DS'.)

Bracket = Trivalent unichrome coating

Product number	Wheels	Wheel diameter	Wheel width	Mounting height	Pipe diameter	Axis length	Opposite side	Eccentricity	Turning radius	Allowance load	Wheel weight	
		D(mm)	W(mm)	H(mm)	d(mm)	L(mm)	M(mm)	E(mm)	R(mm)	daN(kgf)	(g)	
STF-50	RH Rubber wheel	50	28	A=74 B=77					27	67	50(51.0)	385
	N Nylon wheel										60(61.2)	360
	UR Urethane wheel with nylon wheel assembly										60(61.2)	380
STF-65	RH Rubber wheel	65	25	A=89 B=92	22	40	21	27	68		50(51.0)	450
	N Nylon wheel										70(71.4)	385
	UR Urethane wheel with nylon wheel assembly										60(61.2)	410
	EL Elastomer wheel										40(40.8)	410
STF-75	RH Rubber wheel	75	25	A=97 B=100	34	60	21	28	70		60(61.2)	490
	NR Rubber wheel with nylon wheel assembly										60(61.2)	435
	NRB Rubber wheel with nylon wheel assembly (including B)										60(61.2)	475
	N Nylon wheel										70(71.4)	400
	UR Urethane wheel with nylon wheel assembly										70(71.4)	425
	UHF Urethane wheel with nylon wheel assembly (including B)										70(71.4)	470
EL Elastomer wheel	50(51.0)	430										

● These casters are used for only locking rotation of the wheel.
● For nylon wheels, black wheels can be manufactured.
★ Refer to P8 for the mounting method.

Wheel in use Refer to P155 for detailed specifications.



E TYPE



E-100N

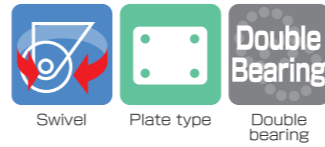
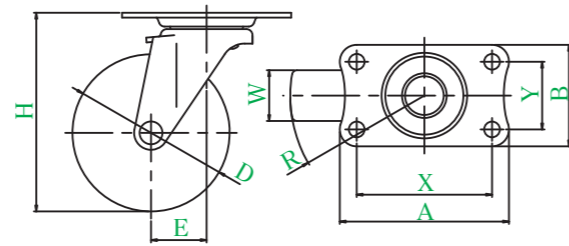

● Description of product number

E - 100 N

Bracket type
Wheel diameter
Wheel type

Bracket = Chrome plating finish

Product number	Wheels	Wheel diameter	Wheel width	Mounting height	Mounting base	Mounting dimensions	Hole diameter	Eccentricity	Turning radius	Allowance load	Wheel weight
		D(mm)	W(mm)	H(mm)	A × B(mm)	X × Y(mm)	P(mm)	E(mm)	R(mm)	daN(kgf)	(g)
E-50	R Rubber wheel	50	20	65	70 × 42	56 × 28	6.5	22	47	30(30.6)	175
	N Nylon wheel		40(40.8)							150	
	UR Urethane wheel with nylon wheel assembly		38(38.8)							160	
	EL Elastomer wheel		25(25.5)							150	
E-65	RH Rubber wheel	65	21	82	70 × 42	56 × 28	6.5	23	56	30(30.6)	225
	N Nylon wheel									40(40.8)	175
	UR Urethane wheel with nylon wheel assembly									40(40.8)	185
E-75	RH Rubber wheel	75	21	92	70 × 42	56 × 28	6.5	27	65	40(40.8)	260
	N Nylon wheel									50(51.0)	185
	UR Urethane wheel with nylon wheel assembly									45(45.9)	205
	EL Elastomer wheel									30(30.6)	210
E-100	RH Rubber wheel	100	25	122	100 × 58	82 × 40	8.8	31	82	50(51.0)	540
	NR Rubber wheel with nylon wheel assembly		60(61.2)							460	
	NRB Rubber wheel with nylon wheel assembly (including B)		60(61.2)							500	
	N Nylon wheel		25							390	
	UR Urethane wheel with nylon wheel assembly		28							425	
	UHF Urethane wheel with nylon wheel assembly (including B)		27							470	
E-125	EL Elastomer wheel	27	415								
E-125	RH Rubber wheel	125	25	148	100 × 58	82 × 40	8.8	36	99	50(51.0)	730

- For nylon wheels, black wheels can be manufactured.
- Conductive rubber wheel can be manufactured.
- The antistatic urethane wheel having wheel diameter of φ 100 can be manufactured.
- Trivalent unichrome coating finish is available.

Wheel in use

Refer to P155 for detailed specifications.



E-S TYPE

• Equipped with a pedal type single stopper



E-100NS

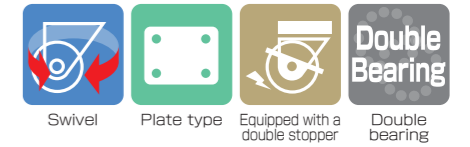
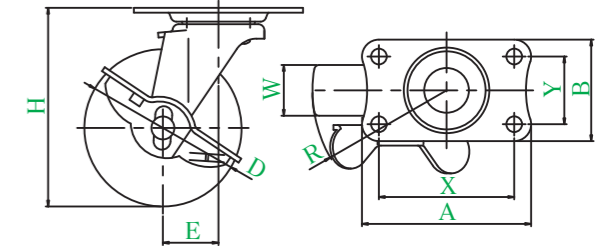

● Description of product number

E - 100 N S

Bracket type
Wheel diameter
Wheel type
Equipped with stopper

(* 'S' indicates that a stopper is equipped. If wheel type is NRB or UHF, please describe 'DS'.*)

Bracket = Chrome plating finish

Product number	Wheels	Wheel diameter	Wheel width	Mounting height	Mounting base	Mounting dimensions	Hole diameter	Eccentricity	Turning radius	Allowance load	Wheel weight
		D(mm)	W(mm)	H(mm)	A × B(mm)	X × Y(mm)	P(mm)	E(mm)	R(mm)	daN(kgf)	(g)
E-50	R Rubber wheel	50	20	65	70 × 42	56 × 28	6.5	22	49	30(30.6)	195
	N Nylon wheel		40(40.8)							170	
	UR S Urethane wheel with nylon wheel assembly		38(38.8)							180	
	EL Elastomer wheel		25(25.5)							170	
E-65	RH Rubber wheel	65	21	82	70 × 42	56 × 28	6.5	23	57	30(30.6)	255
	N Nylon wheel									40(40.8)	205
	UR Urethane wheel with nylon wheel assembly									40(40.8)	210
E-75	RH Rubber wheel	75	21	92	70 × 42	56 × 28	6.5	27	65	40(40.8)	290
	N Nylon wheel									50(51.0)	215
	UR S Urethane wheel with nylon wheel assembly									45(45.9)	230
	EL Elastomer wheel									30(30.6)	240
E-100	RH S Rubber wheel	100	25	122	100 × 58	82 × 40	8.8	31	82	50(51.0)	615
	NR Rubber wheel with nylon wheel assembly		60(61.2)							525	
	NRB DS Rubber wheel with nylon wheel assembly (including B)		60(61.2)							565	
	N Nylon wheel		25							460	
	UR S Urethane wheel with nylon wheel assembly		28							490	
	UHF DS Urethane wheel with nylon wheel assembly (including B)		27							535	
E-125	EL S Elastomer wheel	27	475								
E-125	RH S Rubber wheel	125	25	148	100 × 58	82 × 40	8.8	36	99	50(51.0)	800

- These casters are used for only locking rotation of the wheel.
- For nylon wheels, black wheels can be manufactured.
- Conductive rubber wheel can be manufactured.
- The antistatic urethane wheel having wheel diameter of φ 100 can be manufactured.
- Trivalent unichrome coating finish is available.

Wheel in use

Refer to P155 for detailed specifications.



ER TYPE

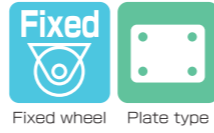

ER-100N

ER-75UR

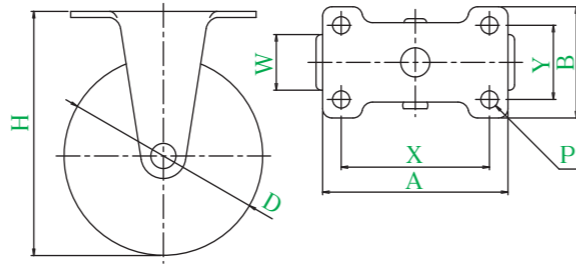

● Description of product number

ER - 100 N

Bracket type
Wheel diameter
Wheel type

Bracket = Chrome plating finish

Product number	Wheels	Wheel diameter	Wheel width	Mounting height	Mounting base	Mounting dimensions	Hole diameter	Allowance load	Wheel weight
		D(mm)	W(mm)	H(mm)	A × B(mm)	X × Y(mm)	P(mm)	daN(kgf)	(g)
ER-50	R Rubber wheel	50	20	65	70 × 42	56 × 28	6.5	30(30.6)	135
	N Nylon wheel		21					40(40.8)	110
	UR Urethane wheel with nylon wheel assembly		20					38(38.8)	120
	EL Elastomer wheel		20					25(25.5)	110
ER-65	RH Rubber wheel	65	21	82	70 × 42	56 × 28	6.5	30(30.6)	185
	N Nylon wheel							40(40.8)	135
	UR Urethane wheel with nylon wheel assembly							40(40.8)	145
ER-75	RH Rubber wheel	75	21	92	70 × 42	56 × 28	6.5	40(40.8)	215
	N Nylon wheel							50(51.0)	145
	UR Urethane wheel with nylon wheel assembly							45(45.9)	160
	EL Elastomer wheel							30(30.6)	175
ER-100	RH Rubber wheel	100	25	122	100 × 58	82 × 40	8.8	50(51.0)	480
	NR Rubber wheel with nylon wheel assembly		27					60(61.2)	400
	NRB Rubber wheel with nylon wheel assembly (including B)		27					60(61.2)	440
	N Nylon wheel		25					60(61.2)	325
	UR Urethane wheel with nylon wheel assembly		28					60(61.2)	355
	UHF Urethane wheel with nylon wheel assembly (including B)		28					60(61.2)	410
ER-125	EL Elastomer wheel	125	27	148	100 × 58	82 × 40	8.8	50(51.0)	345
	RH Rubber wheel		25					50(51.0)	645

- For nylon wheels, black wheels can be manufactured.
- The antistatic urethane wheel having wheel diameter of φ 100 can be manufactured.
- Conductive rubber wheel can be manufactured.
- Trivalent unichrome coating finish is available.

Wheel in use

Refer to P155 for detailed specifications.



ET TYPE

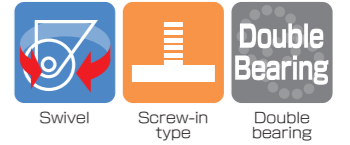

ET-100N, M12 × 35

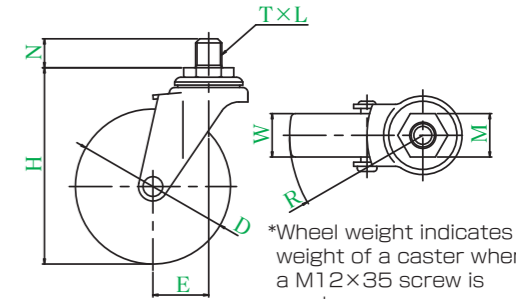

*Wheel weight indicates weight of a caster when a M12 × 35 screw is used.

● Description of product number
Please specify screw type and length.

ET - 100 N , M12 × 35

Bracket type
Wheel diameter
Wheel type
Screw
Length

Bracket = Chrome plating finish

Product number	Wheels	Wheel diameter	Wheel width	Mounting height	Screw	Pitch and threads Per inch	Length	Opposite side	Eccentricity	Turning radius	Allowance load	Wheel weight
		D(mm)	W(mm)	H(mm)	T	L	N(mm)	M(mm)	E(mm)	R(mm)	daN(kgf)	(g)
ET-50	R Rubber wheel	50	20	68	M12	1.75	35	19	22	47	30(30.6)	180
	N Nylon wheel		21								40(40.8)	155
	UR Urethane wheel with nylon wheel assembly		20								38(38.8)	165
	EL Elastomer wheel		20								25(25.5)	155
ET-65	RH Rubber wheel	65	21	85	UNF1/2	20 threads	14	21	23	56	30(30.6)	230
	N Nylon wheel										40(40.8)	180
	UR Urethane wheel with nylon wheel assembly										40(40.8)	190
ET-75	RH Rubber wheel	75	21	95	W3/8	16 threads	14	17	27	65	40(40.8)	260
	N Nylon wheel										50(51.0)	190
	UR Urethane wheel with nylon wheel assembly										45(45.9)	205
	EL Elastomer wheel										30(30.6)	210
ET-100	RH Rubber wheel	100	25	126	M12	1.75	35	21	31	82	50(51.0)	525
	NR Rubber wheel with nylon wheel assembly		27								60(61.2)	445
	NRB Rubber wheel with nylon wheel assembly (including B)		27								60(61.2)	485
	N Nylon wheel		25								60(61.2)	375
	UR Urethane wheel with nylon wheel assembly		28								60(61.2)	405
	UHF Urethane wheel with nylon wheel assembly (including B)		28								60(61.2)	455
ET-125	EL Elastomer wheel	125	27	152	W3/4	10 threads	40	23	36	99	50(51.0)	715
	RH Rubber wheel		25								50(51.0)	715

- For nylon wheels, black wheels can be manufactured.
- Conductive rubber wheel can be manufactured.
- The antistatic urethane wheel having wheel diameter of φ 100 can be manufactured.
- Some types of screws may not be in stock.
- For W3/8 screw, the maximum allowable load is 35daN (35.7kgf).
- Allowable load is the allowable load when the stem is screwed in to the end.
- Trivalent unichrome coating finish is available.
- ★ Refer to P7 for the mounting method.

Wheel in use

Refer to P155 for detailed specifications.



ET-S TYPE

• Equipped with a pedal type single stopper



ET-100RHS, M16×40



ET-100UHFD, M16×40

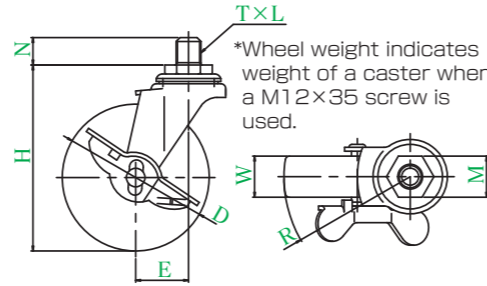

*Wheel weight indicates weight of a caster when a M12×35 screw is used.

● Description of product number
Please specify screw type and length.

ET - 100 UHF S , M16 × 40

Bracket type	Wheel diameter	Wheel type	Equipped with stopper	Screw	Length

(* "S" indicates that a stopper is equipped. If wheel type is NRB or UHF, please describe "DS".)

Bracket = Chrome plating finish

Product number	Wheels	Wheel diameter	Wheel width	Mounting height	Screw	Pitch and threads Per inch	Length	Opposite side	Eccentricity	Turning radius	Allowance load	Wheel weight
		D(mm)	W(mm)	H(mm)	T	L	N(mm)	M(mm)	E(mm)	R(mm)	daN(kgf)	(g)
ET-50	R	50	20	68	M12	1.75	35	19	22	49	30(30.6)	200
	N		40(40.8)								180	
	UR		21								38(38.8)	185
	EL		20								25(25.5)	175
ET-65	RH	65	21	85	UNF1/2	20 threads	14	21	23	57	30(30.6)	260
	N										40(40.8)	205
	UR										40(40.8)	215
	EL										40(40.8)	295
ET-75	RH	75	21	95	W3/8	16 threads	14	17	27	65	40(40.8)	295
	N										50(51.0)	220
	UR										45(45.9)	235
	EL										30(30.6)	240
ET-100	RH	100	25	126	M12	1.75	35	21	31	82	50(51.0)	600
	NR		27								60(61.2)	510
	NRB		25								60(61.2)	550
	N		25								60(61.2)	435
	UR		28								60(61.2)	470
	UHF		28								60(61.2)	520
ET-125	RH	125	25	152	W3/4	10 threads	40	23	36	99	50(51.0)	790
	S		50(51.0)								790	

- For nylon wheels, black wheels can be manufactured.
- Conductive rubber wheel can be manufactured.
- The antistatic urethane wheel having wheel diameter of φ 100 can be manufactured.
- Some types of screws may not be in stock.
- For W3/8 screw, the maximum allowable load is 35daN (35.7kgf).
- These casters are used for only locking rotation of the wheel.
- Allowable load is the allowable load when the stem is screwed in to the end.
- Trivalent unichrome coating finish is available.
- ★ Refer to P7 for the mounting method.

Wheel in use Refer to P155 for detailed specifications.



ETF TYPE

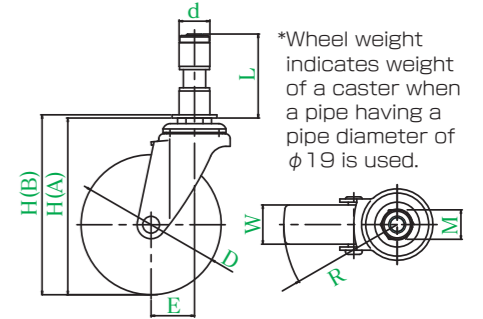
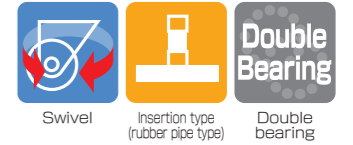

*Wheel weight indicates weight of a caster when a pipe diameter of φ 19 is used.

● Description of product number
Please specify the pipe diameter.

ETF - 100 UR , φ 22

Bracket type	Wheel diameter	Wheel type	Pipe diameter

Bracket = Chrome plating finish

Product number	Wheels	Wheel diameter	Wheel width	Mounting height	Pipe diameter	Axis length	Opposite side	Eccentricity	Turning radius	Allowance load	Wheel weight
		D(mm)	W(mm)	H(mm)	d(mm)	L(mm)	M(mm)	E(mm)	R(mm)	daN(kgf)	(g)
ETF-100	RH	100	25	A = 126 B = 128	19	60	21	31	82	50(51.0)	580
	NR		27							60(61.2)	500
	NRB		25							60(61.2)	540
	N		25							60(61.2)	385
	UR		28							60(61.2)	465
	UHF		28							60(61.2)	530
ETF-125	RH	125	25	A = 152 B = 154	34	60	21	36	99	50(51.0)	770
	S		50(51.0)							770	

- For nylon wheels, black wheels can be manufactured.
- Trivalent unichrome coating finish is available.
- ★ Refer to P8 for the mounting method.

Wheel in use Refer to P155 for detailed specifications.



ETF-S TYPE

• Equipped with a pedal type single stopper

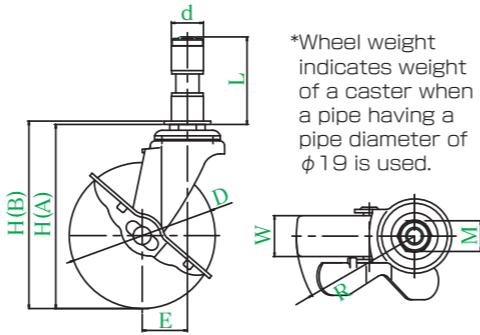
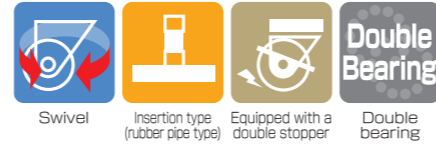

*Wheel weight indicates weight of a caster when a pipe having a pipe diameter of $\phi 19$ is used.

● Description of product number
Please specify the pipe diameter.

ETF - 100 N S , $\phi 22$

Bracket type
Wheel diameter
Wheel type
Equipped with stopper
Pipe diameter

(* 'S' indicates that a stopper is equipped.
If wheel type is NRB or UHF, please describe 'DS'.)

Bracket = Chrome plating finish

Product number	Wheels	Wheel diameter	Wheel width	Mounting height	Pipe diameter	Axis length	Opposite side	Eccentricity	Turning radius	Allowance load	Wheel weight
		D(mm)	W(mm)	H(mm)	d(mm)	L(mm)	M(mm)	E(mm)	R(mm)	daN(kgf)	(g)
ETF-100	RH S Rubber wheel	100	25	A = 126 B = 128	19	60	21	31	82	50(51.0)	650
	NR S Rubber wheel with nylon wheel assembly		27							60(61.2)	570
	NRB DS Rubber wheel with nylon wheel assembly (including B)		25							60(61.2)	605
	N S Nylon wheel		25							60(61.2)	495
	UR S Urethane wheel with nylon wheel assembly		28							60(61.2)	525
	UHF DS Urethane wheel with nylon wheel assembly (including B)		34							60	21
ETF-125	EL S Elastomer wheel	125	25	A = 152 B = 154				36	99	50(51.0)	520
	RH S Rubber wheel	25	50(51.0)							840	

- These casters are used for only locking rotation of the wheel.
- For nylon wheels, black wheels can be manufactured.
- Trivalent unichrome coating finish is available.
- ★ Refer to P8 for the mounting method.

Wheel in use Refer to P155 for detailed specifications.



G TYPE



There are some non-conforming products.

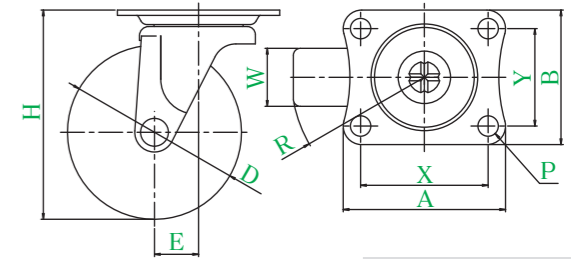
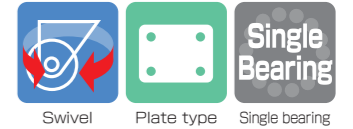

G-50UR

● Description of product number
G - 50 N
Bracket type
Wheel diameter
Wheel type

Notice of revision of specifications: For casters that will be shipped after April 2012, surface treatment will be changed from chrome plating to trivalent unichrome coating. Bracket = Trivalent unichrome coating

Product number	Wheels	Wheel diameter	Wheel width	Mounting height	Mounting base	Mounting dimensions	Hole diameter	Eccentricity	Turning radius	Allowance load	Wheel weight
		D(mm)	W(mm)	H(mm)	A × B(mm)	X × Y(mm)	P(mm)	E(mm)	R(mm)	daN(kgf)	(g)
G-25	R Rubber wheel	25	12	35	35 × 30	28 × 23	4.2	8	21	8(8.2)	35
	N Nylon wheel									10(10.2)	35
	UR Urethane wheel with nylon wheel assembly									10(10.2)	35
G-32	R Rubber wheel	32	14	42	38 × 32	30 × 24	4.2	10	27	12(12.2)	50
	N Nylon wheel									18(18.4)	50
	UR Urethane wheel with nylon wheel assembly									18(18.4)	50
G-38	R Rubber wheel	38	17	50	46 × 38	36 × 28	5.3	12	32	20(20.4)	80
	N Nylon wheel									28(28.6)	75
	UR Urethane wheel with nylon wheel assembly									28(28.6)	75
G-50	R Rubber wheel	50	20	65	59 × 47	46 × 35	6.5	16	42	30(30.6)	165
	N Nylon wheel									38(38.8)	145
	UR Urethane wheel with nylon wheel assembly									38(38.8)	150
G-65	EL Elastomer wheel	65	21	80	70 × 58	55 × 42	8.8	21	54	25(25.5)	140
	RH Rubber wheel									40(40.8)	300
	N Nylon wheel									55(56.1)	240
G-75	UR Urethane wheel with nylon wheel assembly	75	26	90	70 × 58	55 × 42	8.8	21	59	55(56.1)	260
	RH Rubber wheel									50(51.0)	345
	N Nylon wheel									65(66.3)	255
G-75	EL Elastomer wheel	75	27	90	70 × 58	55 × 42	8.8	21	59	65(66.3)	280
	UR Urethane wheel with nylon wheel assembly									50(51.0)	280

- Conductive rubber wheel having wheel diameter of $\phi 50$ and $\phi 75$ can be manufactured.
- For nylon wheels having a wheel diameter of $\phi 50$ to $\phi 75$, black wheels can be manufactured.
- For casters having a wheel diameter of $\phi 50$ to $\phi 75$, chrome plating finish is available.

Wheel in use Refer to P156 for detailed specifications.

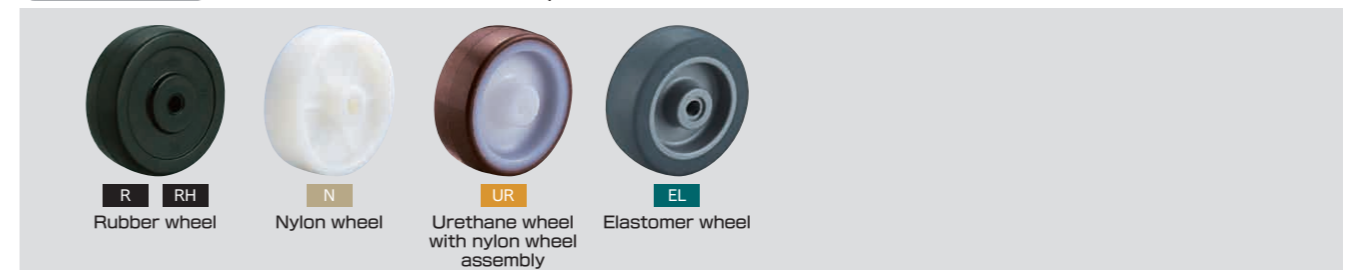

G-S TYPE



There are some non-conforming products.

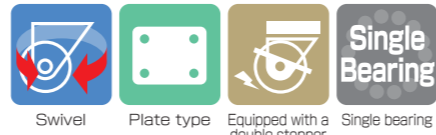

• Equipped with a pedal type single stopper



G-75RHS

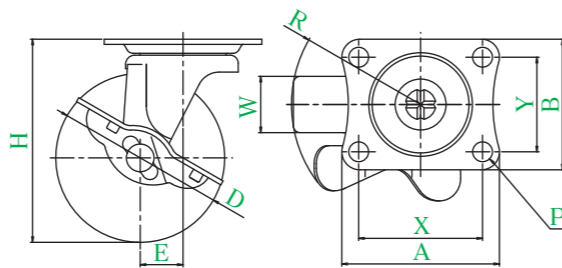

● Description of product number

G - 65 RH S

Bracket type
Wheel diameter
Wheel type
Equipped with stopper

Notice of revision of specifications: For casters that will be shipped after April 2012, surface treatment will be changed from chrome plating to trivalent unichrome coating. Bracket = Trivalent unichrome coating

Product number	Wheels	Wheel diameter	Wheel width	Mounting height	Mounting base	Mounting dimensions	Hole diameter	Eccentricity	Turning radius	Allowance load	Wheel weight
		D(mm)	W(mm)	H(mm)	A × B(mm)	X × Y(mm)	P(mm)	E(mm)	R(mm)	daN(kgf)	(g)
G-38	R Rubber wheel	38	17	50	46 × 38	36 × 28	5.3	12	45	20(20.4)	95
	N Nylon wheel		16							28(28.6)	90
	UR Urethane wheel with nylon wheel assembly		16							28(28.6)	90
G-50	R Rubber wheel	50	20	65	59 × 47	46 × 35	6.5	16	50	30(30.6)	195
	N Nylon wheel		21							38(38.8)	170
	UR Urethane wheel with nylon wheel assembly		21							38(38.8)	180
	EL Elastomer wheel		20							25(25.5)	170
G-65	RH Rubber wheel	65	25	80	70 × 58	55 × 42	8.8	21	59	40(40.8)	350
	N Nylon wheel		25							55(56.1)	275
	UR Urethane wheel with nylon wheel assembly		25							55(56.1)	310
	EL Elastomer wheel		27							40(40.8)	170
G-75	RH Rubber wheel	75	25	90	70 × 58	55 × 42	8.8	21	59	50(51.0)	390
	N Nylon wheel		25							65(66.3)	295
	UR Urethane wheel with nylon wheel assembly		26							65(66.3)	320
	EL Elastomer wheel		27							50(51.0)	320

- These casters are used for only locking rotation of the wheel.
- Conductive rubber wheel having wheel diameter of φ 50 and φ 75 can be manufactured.
- For nylon wheels having a wheel diameter of φ 50 to φ 75, black wheels can be manufactured.
- For casters having a wheel diameter of φ 50 to φ 75, chrome plating finish is available.

Wheel in use Refer to P156 for detailed specifications.



GR TYPE



There are some non-conforming products.

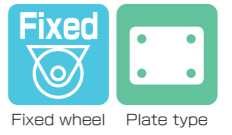

GR-65N

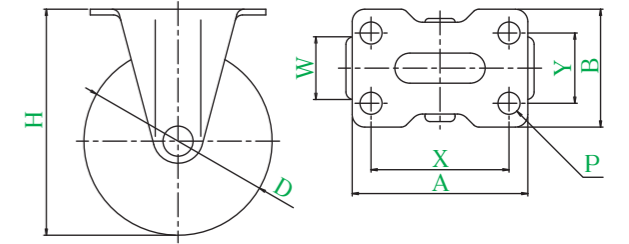

● Description of product number
GR - 75 UR
Bracket type
Wheel diameter
Wheel type

Notice of revision of specifications: For casters that will be shipped after April 2012, surface treatment will be changed from chrome plating to trivalent unichrome coating. Bracket = Trivalent unichrome coating

Product number	Wheels	Wheel diameter	Wheel width	Mounting height	Mounting base	Mounting dimensions	Hole diameter	Allowance load	Wheel weight
		D(mm)	W(mm)	H(mm)	A × B(mm)	X × Y(mm)	P(mm)	daN(kgf)	(g)
GR-25	R Rubber wheel	25	12	35	36 × 18	29 × 0	4.2	8(8.2)	25
	N Nylon wheel							10(10.2)	25
	UR Urethane wheel with nylon wheel assembly							10(10.2)	25
GR-32	R Rubber wheel	32	14	42	36 × 20	29 × 0	4.2	12(12.2)	35
	N Nylon wheel							18(18.4)	35
	UR Urethane wheel with nylon wheel assembly							18(18.4)	35
GR-38	R Rubber wheel	38	17	50	46 × 25	36 × 15	5.3	20(20.4)	55
	N Nylon wheel		16					28(28.6)	50
	UR Urethane wheel with nylon wheel assembly		16					28(28.6)	55
GR-50	R Rubber wheel	50	20	65	58 × 40	45 × 25	6.5	30(30.6)	125
	N Nylon wheel		21					38(38.8)	95
	UR Urethane wheel with nylon wheel assembly		21					38(38.8)	105
	EL Elastomer wheel		20					25(25.5)	100
GR-65	RH Rubber wheel	65	25	80	70 × 47	55 × 28	8.8	40(40.8)	225
	N Nylon wheel		25					55(56.1)	165
	UR Urethane wheel with nylon wheel assembly		25					55(56.1)	185
	EL Elastomer wheel		27					40(40.8)	170
GR-75	RH Rubber wheel	75	25	90	70 × 47	55 × 28	8.8	50(51.0)	275
	N Nylon wheel		25					65(66.3)	185
	UR Urethane wheel with nylon wheel assembly		26					65(66.3)	210
	EL Elastomer wheel		27					50(51.0)	210

- Conductive rubber wheel having wheel diameter of φ 50 and φ 75 can be manufactured.
- For nylon wheels having a wheel diameter of φ 50 to φ 75, black wheels can be manufactured.
- For casters having a wheel diameter of φ 50 to φ 75, chrome plating finish is available.

Wheel in use Refer to P156 for detailed specifications.



GTYPE

Polycarbonate wheel



There are some non-conforming products.

Colors of G series wheels can be selected!

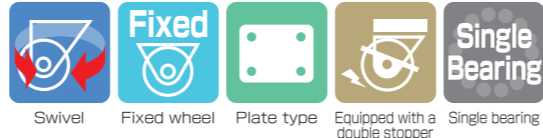

G-50PC-G

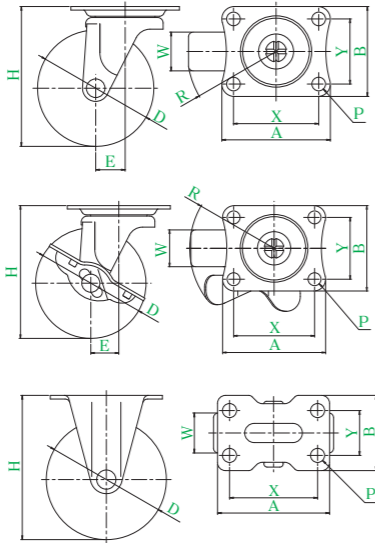

● Description of product number

G - 50 PC S - color symbol

Bracket type
Wheel diameter
Wheel type
Availability of a stopper
*The following color symbols shall be entered at the end of the product number.
Transparent ...C
Red ...R
Green ...G

G type specifications

Bracket = Trivalent unichrome coating (wheel diameter: φ 25 to φ 38)
Chrome plating finish (wheel diameter: φ 50)

Product number	Wheels	Wheel diameter	Wheel width	Mounting height	Mounting base	Mounting dimensions	Hole diameter	Eccentricity	Turning radius	Allowance load	Wheel weight		
		D(mm)	(mm)	H(mm)	A × B(mm)	X × Y(mm)	P(mm)	E(mm)	(mm)	daN(kgf)	(g)		
G-25	PC	-Color symbol	Polycarbonate wheel	25	12	35	35 × 30	28 × 23	4.2	8	21	10(10.2)	30
G-38	PC	-Color symbol	Polycarbonate wheel	38	16	50	46 × 38	36 × 28	5.3	12	32	28(28.6)	75
G-50	PC	-Color symbol	Polycarbonate wheel	50	21	65	59 × 47	46 × 35	6.5	16	42	38(38.8)	110
G-38	PC S	-Color symbol	Polycarbonate wheel	38	16	50	46 × 38	36 × 28	5.3	12	45	28(28.6)	105
G-50	PC S	-Color symbol	Polycarbonate wheel	50	21	65	59 × 47	46 × 35	6.5	16	50	38(38.8)	135

- If the symbol "S" is entered at the end of the product number, the caster is equipped with a stopper that only locks rotation of a wheel.
- For casters having a wheel diameter of φ 50, Trivalent unichrome coating is available.

Specifications of GR type

Bracket = Trivalent unichrome coating (wheel diameter: φ 25 to φ 38)
Chrome plating finish (wheel diameter: φ 50)

Product number	Wheels	Wheel diameter	Wheel width	Mounting height	Mounting base	Mounting dimensions	Hole diameter	Allowance load	Wheel weight		
		D(mm)	(mm)	H(mm)	A × B(mm)	X × Y(mm)	P(mm)	daN(kgf)	(g)		
GR-25	PC	-Color symbol	Polycarbonate wheel	25	12	35	36 × 18	29 × 0	4.2	10(10.2)	25
GR-38	PC	-Color symbol	Polycarbonate wheel	38	16	50	46 × 25	36 × 15	5.3	28(28.6)	50
GR-50	PC	-Color symbol	Polycarbonate wheel	50	21	65	58 × 40	45 × 25	6.5	38(38.8)	95

- For casters having a wheel diameter of φ 50, Trivalent unichrome coating is available.

Wheel in use

Refer to P156 for detailed specifications.



PC-C Polycarbonate wheel (transparent)
PC-R Polycarbonate wheel (Red)
PC-G Polycarbonate wheel (Green)

LGTYPE

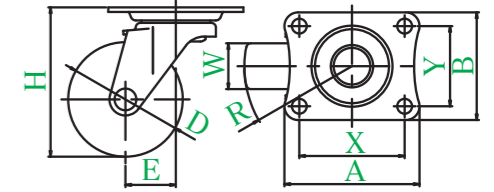
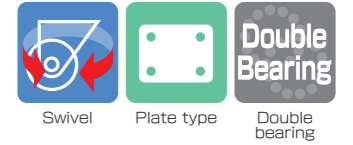

LG-50R

● Description of product number

LG - 50 R

Bracket type
Wheel diameter
Wheel type

Bracket = Trivalent unichrome coating

Product number	Wheels	Wheel diameter	Wheel width	Mounting height	Mounting base	Mounting dimensions	Hole diameter	Eccentricity	Turning radius	Allowance load	Wheel weight	
		D(mm)	W(mm)	H(mm)	A × B(mm)	X × Y(mm)	P(mm)	E(mm)	R(mm)	daN(kgf)	(g)	
LG-50	R	Rubber wheel	50	20	65	59 × 47	46 × 35	6.5	22	47	30(30.6)	160
	N	Nylon wheel	50	21	65	59 × 47	46 × 35	6.5	22	47	40(40.8)	135

- Conductive rubber wheel can be manufactured.
- For nylon wheels, black wheels can be manufactured.

Wheel in use

Refer to P157 for detailed specifications.



R Rubber wheel
N Nylon wheel

LG-S TYPE

• Equipped with a pedal type single stopper



LG-50NS

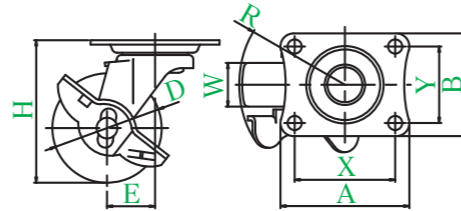
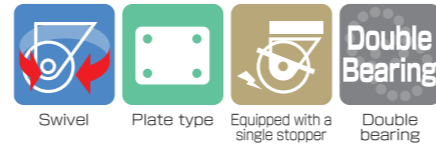

● Description of product number

LG - 50 R S

Bracket type
Wheel diameter
Wheel type
Equipped with stopper

Bracket = Trivalent unichrome coating

Product number	Wheels	Wheel diameter	Wheel width	Mounting height	Mounting base	Mounting dimensions	Hole diameter	Eccentricity	Turning radius	Allowance load	Wheel weight
		D(mm)	W(mm)	H(mm)	A × B(mm)	X × Y(mm)	P(mm)	E(mm)	R(mm)	daN(kgf)	(g)
LG-50	R Rubber wheel	50	20	65	59 × 47	46 × 35	6.5	22	49	30(30.6)	180
	N Nylon wheel		21							40(40.8)	155

- These casters are used for only locking rotation of the wheel.
- Conductive rubber wheel can be manufactured.
- For nylon wheels, black wheels can be manufactured.

Wheel in use

Refer to P157 for detailed specifications.



R
Rubber wheel



N
Nylon wheel

LR TYPE

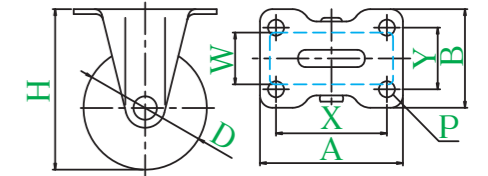
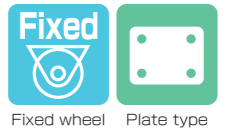

● Description of product number

LR - 50 R

Bracket type
Wheel diameter
Wheel type



LR-50R

Bracket = Trivalent unichrome coating

Product number	Wheels	Wheel diameter	Wheel width	Mounting height	Mounting base	Mounting dimensions	Hole diameter	Allowance load	Wheel weight
		D(mm)	W(mm)	H(mm)	A × B(mm)	X × Y(mm)	P(mm)	daN(kgf)	(g)
LR-50	R Rubber wheel	50	20	65	58 × 40	45 × 25	6.5	30(30.6)	125
	N Nylon wheel		21					40(40.8)	100

- Conductive rubber wheel can be manufactured.
- For nylon wheels, black wheels can be manufactured.

Wheel in use

Refer to P157 for detailed specifications.



R
Rubber wheel



N
Nylon wheel

LT TYPE



LT-50N, M12×14

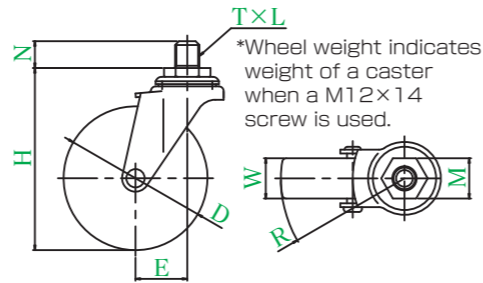

*Wheel weight indicates weight of a caster when a M12×14 screw is used.

● Description of product number
Please specify screw type and length.

LT - 50 N , M12 × 14

Bracket type	Wheel diameter	Wheel type	Screw	Length
--------------	----------------	------------	-------	--------

Bracket = Trivalent unichrome coating

Product number	Wheels	Wheel diameter	Wheel width	Mounting height	Screw	Pitch and threads per inch	Length	Opposite side	Eccentricity	Turning radius	Allowance load	Wheel weight				
		D(mm)	W(mm)	H(mm)	T	L	N(mm)	M(mm)	E(mm)	R(mm)	daN(kgf)	(g)				
LT-40	R Rubber wheel	40	17	59	M12	1.25	14	19	21	41	25(25.5)	135				
LT-50	R Rubber wheel	50	20	68	UNF1/2	20 threads	14	21	22	47	30(30.6)	145				
	N Nylon wheel		21		W3/8	16 threads	14	17			30(30.6)	125				
LT-65	RH Rubber wheel	65	21	85	M12	1.25	14	19	23	56	30(30.6)	190				
	N Nylon wheel										40(40.8)	150				
	UR Urethane wheel with nylon wheel assembly										M12	1.75	35	19	40(40.8)	155
LT-75	RH Rubber wheel	75	21	95	UNF1/2	20 threads	14	21	27	65	40(40.8)	245				
	N Nylon wheel										W3/8	16 threads	14	17	50(51.0)	180
	UR Urethane wheel with nylon wheel assembly														45(45.9)	190

- Conductive rubber wheel having wheel diameter of φ 50 and φ 75 can be manufactured.
- For nylon wheels having a wheel diameter of φ 50 to φ 75, black wheels can be manufactured.
- Some types of screws may not be in stock.
- For W3/8 screw, the maximum allowable load is 35daN (35.7kgf).
- Allowable load is the allowable load when the stem is screwed in to the end.
- ★ Refer to P7 for the mounting method.

Wheel in use

Refer to P157 for detailed specifications.



LT-S TYPE

• Equipped with a pedal type single stopper



LT-50RS, M12×14

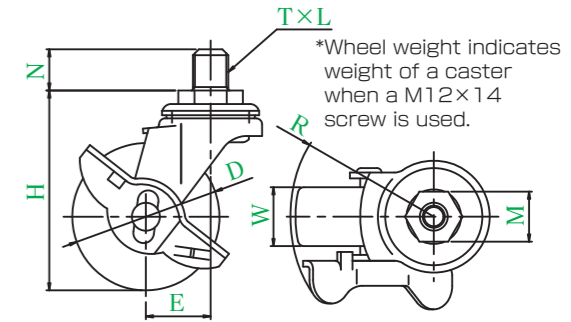

*Wheel weight indicates weight of a caster when a M12×14 screw is used.

● Description of product number
Please specify screw type and length.

LT - 75 RH S , M12 × 14

Bracket type	Wheel diameter	Wheel type	Equipped with stopper	Screw	Length
--------------	----------------	------------	-----------------------	-------	--------

Bracket = Trivalent unichrome coating

Product number	Wheels	Wheel diameter	Wheel width	Mounting height	Screw	Pitch and threads per inch	Length	Opposite side	Eccentricity	Turning radius	Allowance load	Wheel weight				
		D(mm)	W(mm)	H(mm)	T	L	N(mm)	M(mm)	E(mm)	R(mm)	daN(kgf)	(g)				
LT-40	R S Rubber wheel	40	17	59	M12	1.25	14	19	21	50	25(25.5)	155				
LT-50	R S Rubber wheel	50	20	68	UNF1/2	20 threads	14	21	22	49	30(30.6)	170				
	N S Nylon wheel		21		W3/8	16 threads	14	17			30(30.6)	150				
LT-65	RH Rubber wheel	65	21	85	M12	1.25	14	19	23	57	30(30.6)	230				
	N S Nylon wheel										40(40.8)	170				
	UR Urethane wheel with nylon wheel assembly										M12	1.75	35	19	40(40.8)	185
LT-75	RH Rubber wheel	75	21	95	UNF1/2	20 threads	14	21	27	65	40(40.8)	280				
	N S Nylon wheel										W3/8	16 threads	14	17	50(51.0)	210
	UR Urethane wheel with nylon wheel assembly														45(45.9)	220

- These casters are used for only locking rotation of the wheel.
- Conductive rubber wheel having wheel diameter of φ 50 and φ 75 can be manufactured.
- For nylon wheels having a wheel diameter of φ 50 to φ 75, black wheels can be manufactured.
- Some types of screws may not be in stock.
- For W3/8 screw, the maximum allowable load is 35daN (35.7kgf).
- Allowable load is the allowable load when the stem is screwed in to the end.
- ★ Refer to P7 for the mounting method.

Wheel in use

Refer to P157 for detailed specifications.



LTF TYPE

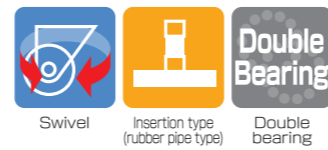

LTF-50R, φ 16

LTF-50N, φ 24

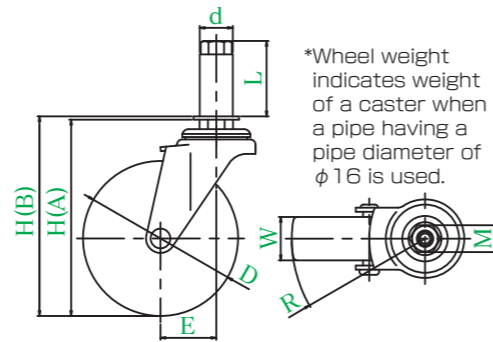

*Wheel weight indicates weight of a caster when a pipe having a pipe diameter of φ 16 is used.

● Description of product number
Please specify the pipe diameter.

LTF - 50 R , φ 16

Bracket type
Wheel diameter
Wheel type
Pipe diameter

Bracket = Trivalent unichrome coating

Product number	Wheels	Wheel diameter	Wheel width	Mounting height	Pipe diameter	Axis length	Opposite side	Eccentricity	Turning radius	Allowance load	Wheel weight
		D(mm)	W(mm)	H(mm)	d(mm)	L(mm)	M(mm)	E(mm)	R(mm)	daN(kgf)	(g)
LTF-40	R Rubber wheel	40	17	A = 59 B = 60				21	41	20(20.4)	145
LTF-50	R Rubber wheel	50	20	A = 68 B = 70	16	38	14	22	47	30(30.6)	190
	N Nylon wheel		21							30(30.6)	170
LTF-65	RH Rubber wheel	65	21	A = 85 B = 87	18	38	14	23	56	30(30.6)	235
	N Nylon wheel									40(40.8)	195
	UR Urethane wheel with nylon wheel assembly									35(35.7)	200
LTF-75	RH Rubber wheel	75	21	A = 95 B = 97	24	38	14	27	65	40(40.8)	260
	N Nylon wheel									50(51.0)	195
	UR Urethane wheel with nylon wheel assembly									45(45.9)	205
	EL Elastomer wheel									30(30.6)	

● For nylon wheels having a wheel diameter of φ 50 to φ 75, black wheels can be manufactured.
★ Refer to P8 for the mounting method.

Wheel in use Refer to P157 for detailed specifications.



LTF-S TYPE

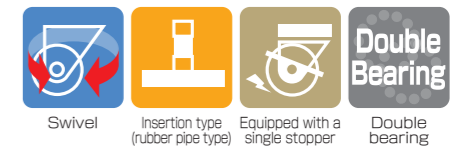

• Equipped with a pedal type single stopper



LTF-50NS, φ 22

LTF-50NS, φ 24

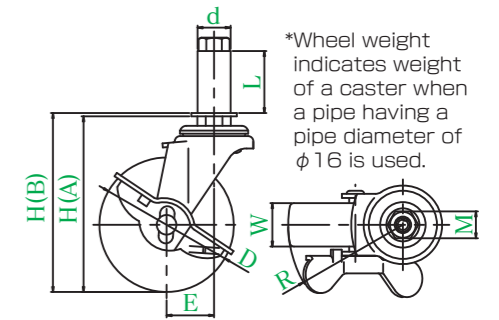

*Wheel weight indicates weight of a caster when a pipe having a pipe diameter of φ 16 is used.

● Description of product number
Please specify the pipe diameter.

LTF - 50 NS , φ 22

Bracket type
Wheel diameter
Wheel type
Equipped with stopper
Pipe diameter

Bracket = Trivalent unichrome coating

Product number	Wheels	Wheel diameter	Wheel width	Mounting height	Pipe diameter	Axis length	Opposite side	Eccentricity	Turning radius	Allowance load	Wheel weight
		D(mm)	W(mm)	H(mm)	d(mm)	L(mm)	M(mm)	E(mm)	R(mm)	daN(kgf)	(g)
LTF-40	R S Rubber wheel	40	17	A = 59 B = 60				21	50	20(20.4)	165
LTF-50	R S Rubber wheel	50	20	A = 68 B = 70	16	38	14	22	49	30(30.6)	240
	N S Nylon wheel		21							30(30.6)	220
LTF-65	RH Rubber wheel	65	21	A = 85 B = 87	18	38	14	23	57	30(30.6)	305
	N S Nylon wheel									40(40.8)	245
	UR Urethane wheel with nylon wheel assembly									35(35.7)	270
LTF-75	RH Rubber wheel	75	21	A = 95 B = 97	24	38	14	27	65	40(40.8)	290
	N S Nylon wheel									50(51.0)	225
	UR Urethane wheel with nylon wheel assembly									45(45.9)	235
	EL Elastomer wheel									30(30.6)	

● These casters are used for only locking rotation of the wheel.
● For nylon wheels having a wheel diameter of φ 50 to φ 75, black wheels can be manufactured.
★ Refer to P8 for the mounting method.

Wheel in use Refer to P157 for detailed specifications.



SA TYPE



There are some non-conforming products.



● Description of product number

SA - 75 RH

Bracket type
Wheel diameter
Wheel type



SA-75RH

SA-100W

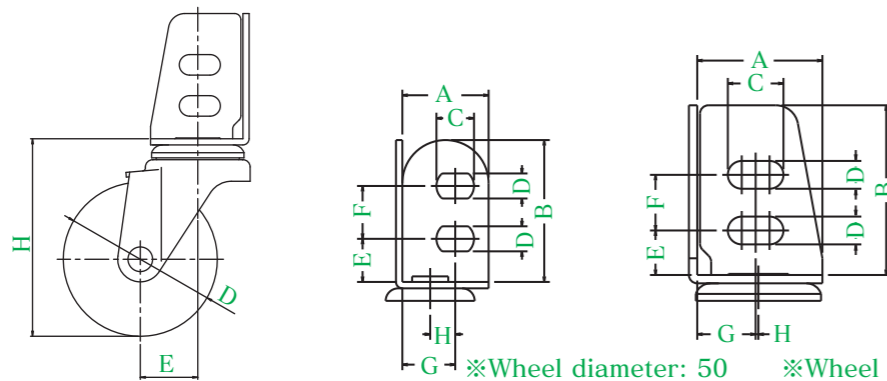

※Wheel diameter: 50 ※Wheel diameter: 65 to 100

Table of specifications of angle

Wheel diameter	A	B	C	D	E	F	G	H
(mm)	(mm)	(mm)	(mm)	(mm)	(mm)	(mm)	(mm)	(mm)
50	31	51	13.5	9	15.5	19	19	4
65	45	61	20	10	16	20	21	1
75								
100								

Bracket = Trivalent unichrome coating

Product number	Wheels	Wheel diameter	Wheel width	Mounting height	Eccentricity	Turning radius	Allowance load	Wheel weight
		D(mm)	W(mm)	H(mm)	E(mm)	R(mm)	daN(kgf)	(g)
SA-50	R Rubber wheel	50	20	65	22	47	30(30.6)	160
	N Nylon wheel		21				40(40.8)	135
SA-65	RH Rubber wheel	65	25	88	27	61	50(51.0)	465
	N Nylon wheel						60(61.2)	415
	UR Urethane wheel with nylon wheel assembly		60(61.2)				425	
	EL Elastomer wheel		40(40.8)				425	
SA-75	RH Rubber wheel	75	25	96	28	66	60(61.2)	505
	NR Rubber wheel with nylon wheel assembly		27				60(61.2)	435
	NRB Rubber wheel with nylon wheel assembly (including B)		27				60(61.2)	475
	N Nylon wheel		25				60(61.2)	420
	UR Urethane wheel with nylon wheel assembly		26				60(61.2)	445
	UHF Urethane wheel with nylon wheel assembly (including B)		27				60(61.2)	475
SA-100	EL Elastomer wheel	100	32	132	32	82	90(91.8)	940
	W Rubber wheel with steel plate wheel assembly (including B)						90(91.8)	890
	WP Rubber wheel with steel plate wheel assembly						90(91.8)	825
	NR Rubber wheel with nylon wheel assembly (including B)					83	90(91.8)	740
	N Nylon wheel						90(91.8)	860
	NB Nylon wheel (including B)						90(91.8)	1030
	UW Urethane wheel with steel plate wheel assembly (including B)						90(91.8)	840
GU Urethane wheel with nylon wheel assembly (including B)	82	90(91.8)	840					

- Conductive rubber wheel can be manufactured.
- The antistatic urethane wheel assembly (including B) having a wheel diameter of φ 100 can be manufactured.
- For nylon wheels having a wheel diameter of φ 50 to φ 75, black wheels can be manufactured.
- ★ Refer to P8 for the mounting method.

Wheel in use Wheel diameter: φ50 to φ75

Refer to P157 for detailed specifications.



Wheel in use Wheel diameter: φ 100

Refer to P158 for detailed specifications.



SA-S TYPE



There are some non-conforming products.



• Equipped with a pedal type single stopper

● Description of product number

SA - 75 RH S

Bracket type
Wheel diameter
Wheel type
Equipped with stopper

(* 'S' indicates that a stopper is equipped. If wheel type is NRB or UHF, please describe 'DS'.*)



SA-75RHS



SA-100WS

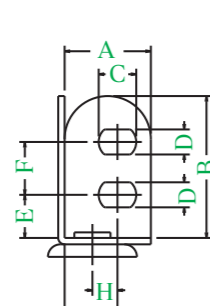
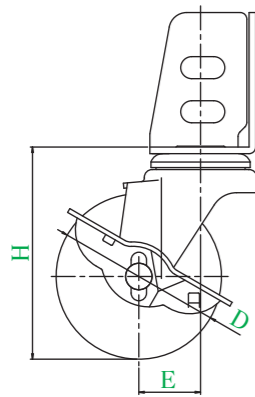

※Wheel diameter: 50

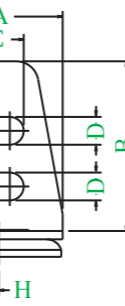

※Wheel diameter: 65 to 100

Table of specifications of angle

Wheel diameter (mm)	A (mm)	B (mm)	C (mm)	D (mm)	E (mm)	F (mm)	G (mm)	H (mm)
50	31	51	13.5	9	15.5	19	19	4
65	45	61	20	10	16	20	21	1
75								
100								

Bracket = Trivalent unichrome coating

Product number	Wheels		Wheel diameter		Wheel width	Mounting height	Eccentricity	Turning radius	Allowance load	Wheel weight		
			D(mm)	W(mm)	H(mm)	E(mm)	R(mm)	daN(kgf)	(g)			
SA-50	R	S	50	20	65	22	49	30(30.6)	210			
	N			21						40(40.8)	185	
SA-65	RH		65	25	88	27	68	50(51.0)	520			
	N									60(61.2)	470	
	UR	S								60(61.2)	480	
	EL									40(40.8)	480	
SA-75	RH		75	25	96	28	68	60(61.2)	560			
	NR	S		27						60(61.2)	505	
	NRB	DS		25						70	60(61.2)	545
	N									68	60(61.2)	465
	UR	S		26						60(61.2)	500	
	UHF	DS		27						70	60(61.2)	540
EL	S	68	50(51.0)		500							
SA-100	W		100	32	132	32	86	90(91.8)	1050			
	WP									90(91.8)	1000	
	NR									90(91.8)	935	
	N	S								90(91.8)	850	
	NB									90(91.8)	945	
	UW									90(91.8)	1140	
	GU									90(91.8)	950	

- These casters are used for only locking rotation of the wheel.
- Conductive rubber wheel can be manufactured.
- The antistatic urethane wheel assembly (including B) having a wheel diameter of φ 100 can be manufactured.
- For nylon wheels having a wheel diameter of φ 50 to φ 75, black wheels can be manufactured.
- ★ Refer to P8 for the mounting method.

Wheel in use Wheel diameter: φ50 to φ75

Refer to P157 for detailed specifications.



Wheel in use Wheel diameter: φ 100

Refer to P158 for detailed specifications.

